



(19) **United States**

(12) **Patent Application Publication**

**Angold et al.**

(10) **Pub. No.: US 2007/0056592 A1**

(43) **Pub. Date: Mar. 15, 2007**

(54) **SEMI-POWERED LOWER EXTREMITY EXOSKELETON**

(75) Inventors: **Rusdon Angold**, American Canyon, CA (US); **Nathan H. Harding**, Oakland, CA (US); **Homayoon Kazerooni**, Berkeley, CA (US)

Correspondence Address:  
**MORRISON & FOERSTER LLP**  
425 MARKET STREET  
SAN FRANCISCO, CA 94105-2482 (US)

(73) Assignee: **The Regents of University of California**, Oakland, CA

(21) Appl. No.: **11/404,719**

(22) Filed: **Apr. 13, 2006**

**Related U.S. Application Data**

(60) Provisional application No. 60/671,348, filed on Apr. 13, 2005.

**Publication Classification**

(51) **Int. Cl.**  
**A61G 15/00** (2006.01)  
**A61F 2/74** (2006.01)

(52) **U.S. Cl.** ..... **128/845; 623/27**

(57) **ABSTRACT**

The lower extremity exoskeleton comprises two leg supports connectable to person's lower limbs and configured to rest on the ground during their stance phase. Each leg support comprises a thigh link and a shank link; a knee joint configured to allow flexion and extension between the shank link and the thigh link. The lower extremity exoskeleton further comprises an exoskeleton trunk connectable to the person's upper body. The exoskeleton trunk is connectable to the thigh links of the leg supports allowing for the flexion and extension between the leg supports and the exoskeleton trunk. Two torque generators are coupled to each of the knee joints. A power unit, capable of providing power, is coupled to the torque generators. In operation when a leg support is in a stance phase and climbing a slope or stairs, the power unit injects power into the respective torque generator thereby extending the respective knee angle. When a leg support is in stance phase and not climbing a slope or stairs, the power unit does not inject any power to the respective torque generator, but without dissipating any stored power in said power unit, it forces the torque generator to resist flexion of the respective knee joint. When a leg support is in a swing phase, the power unit does not inject any power to the respective torque generator, but without dissipating any stored power in said power unit, it forces the torque generator to minimize its resistance to knee flexion and extension.

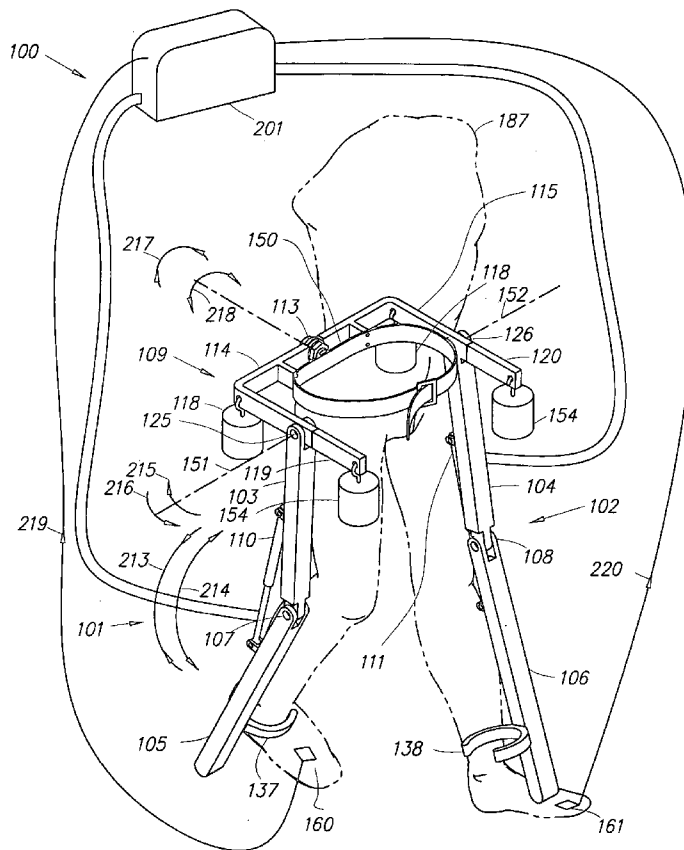

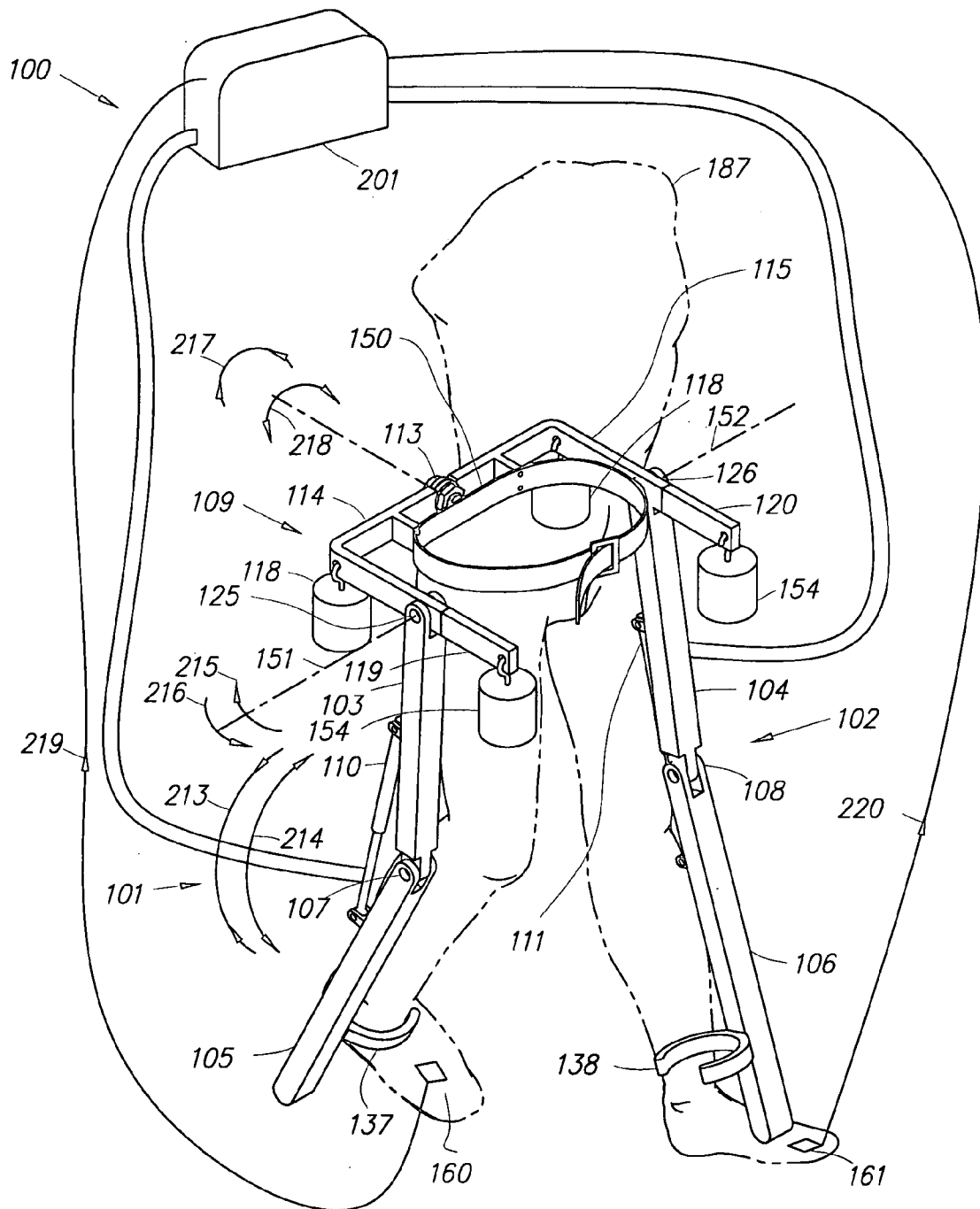

Fig. 1

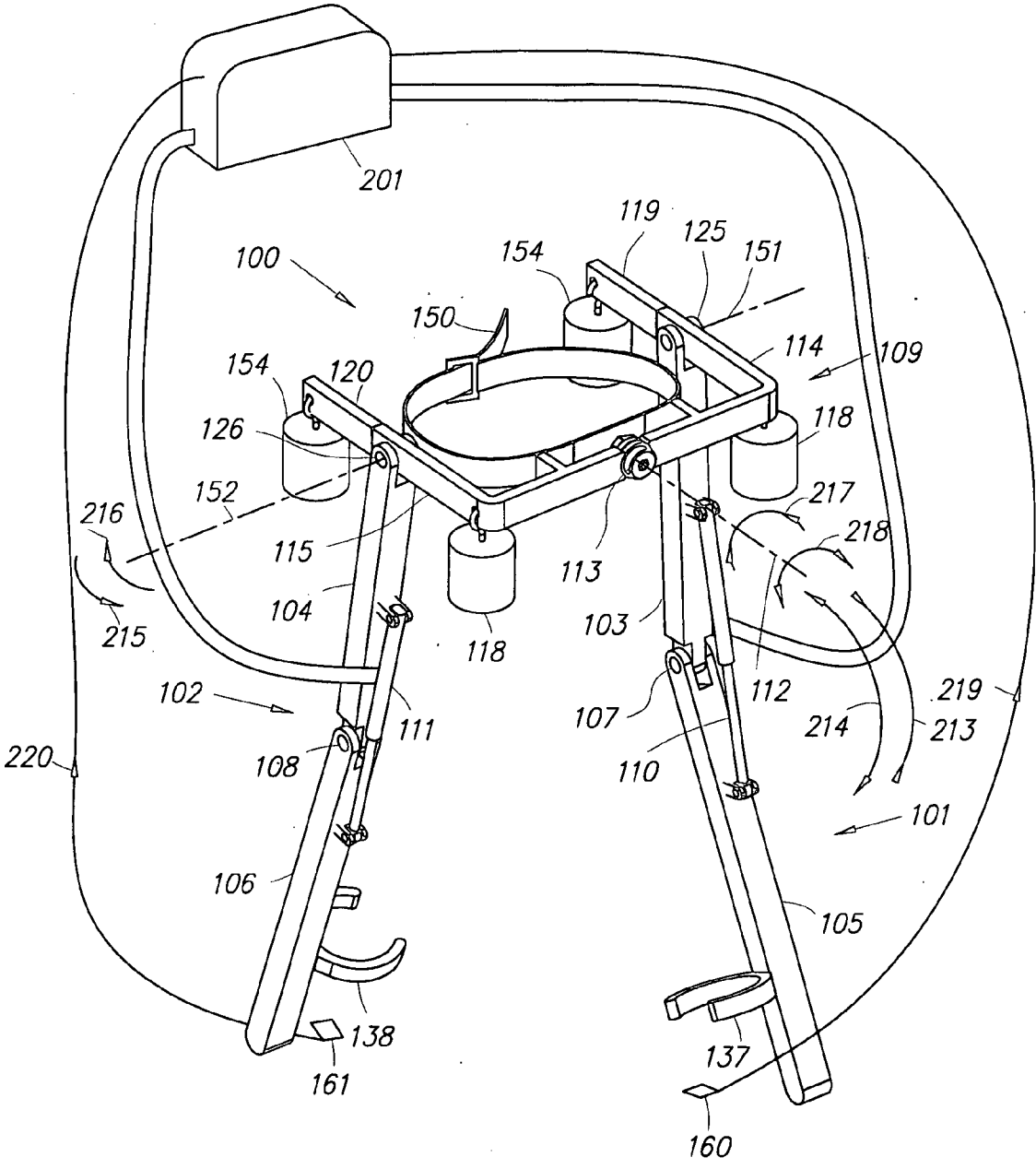

Fig. 2

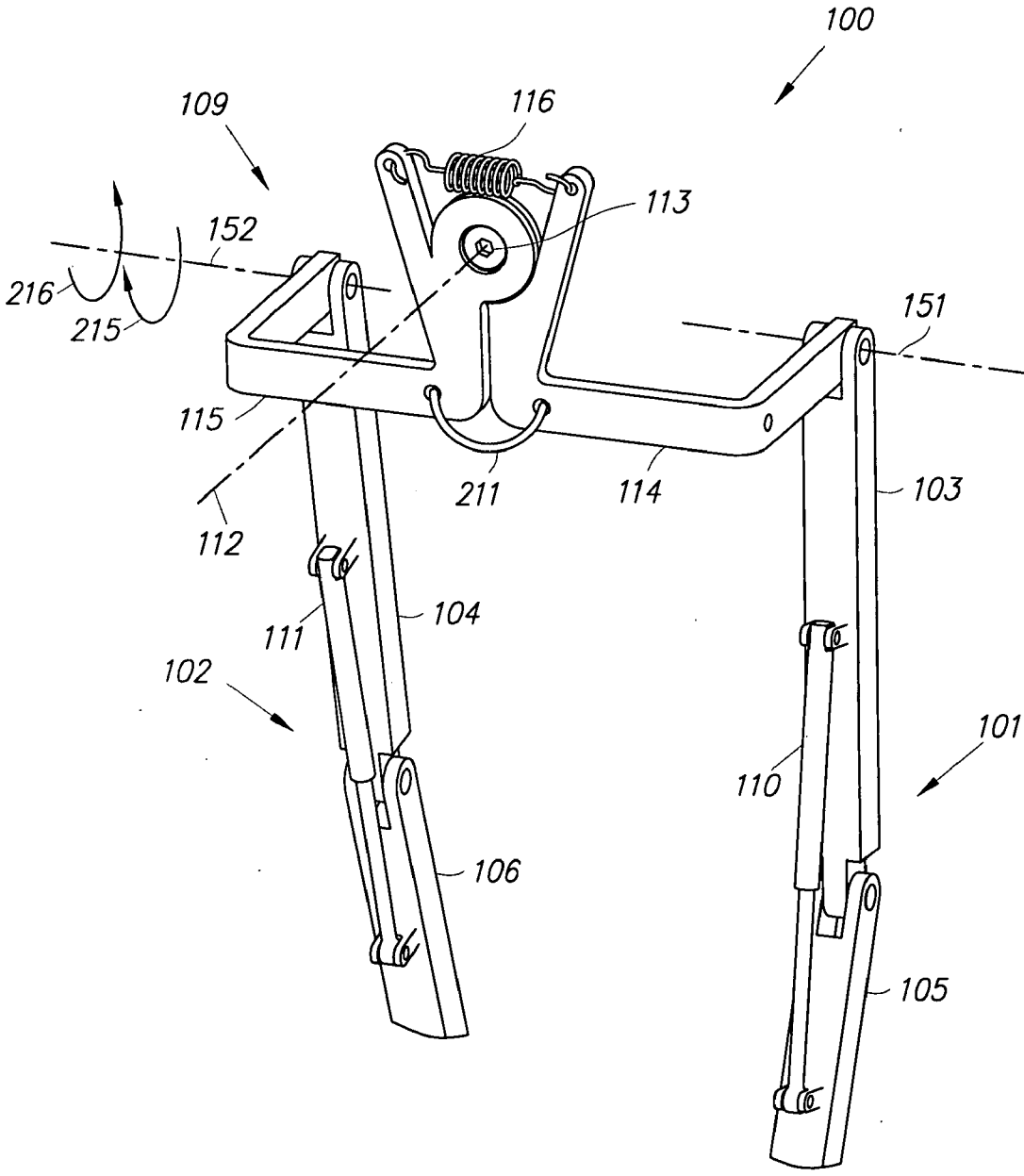

Fig. 3

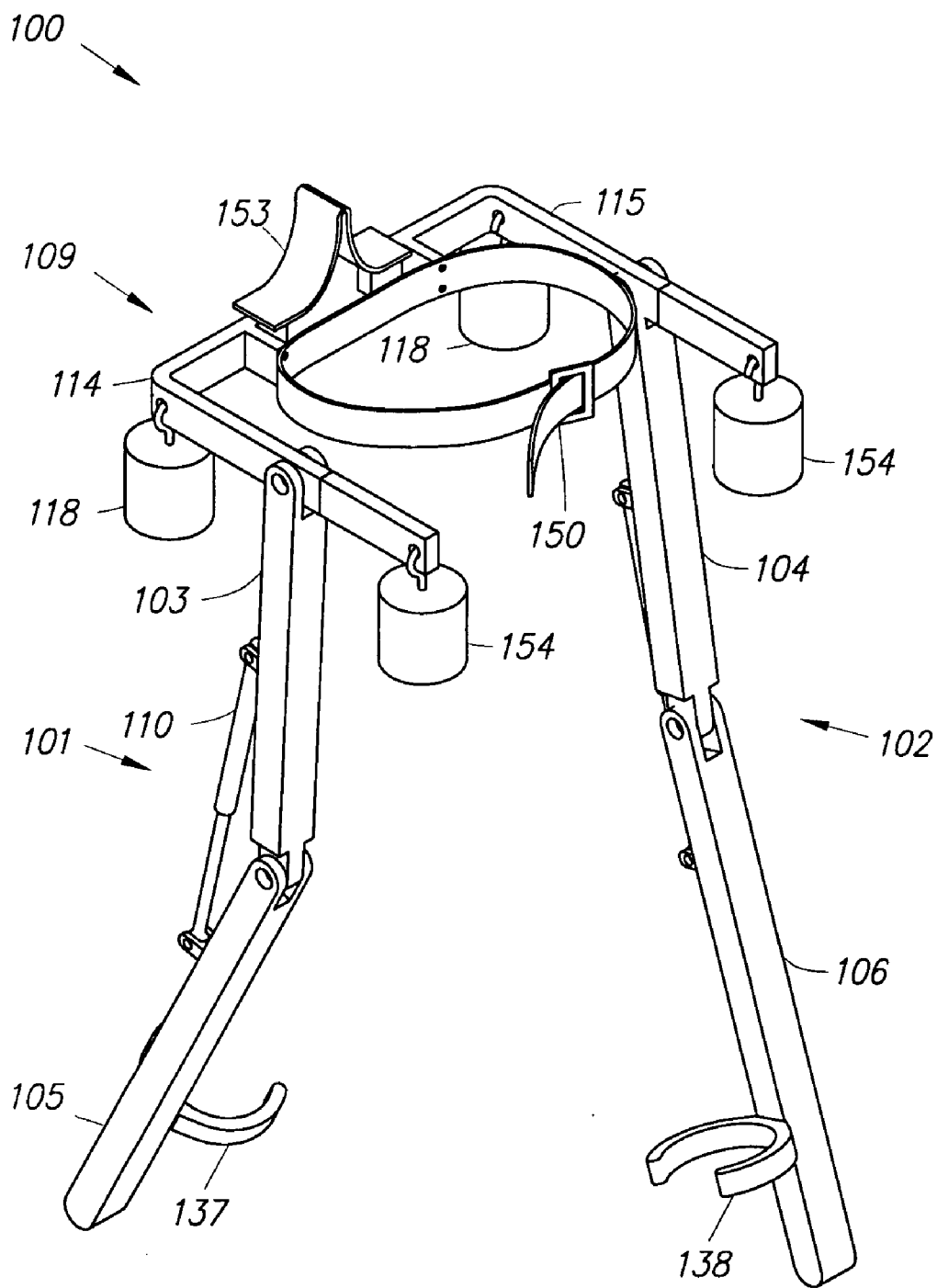

Fig. 4

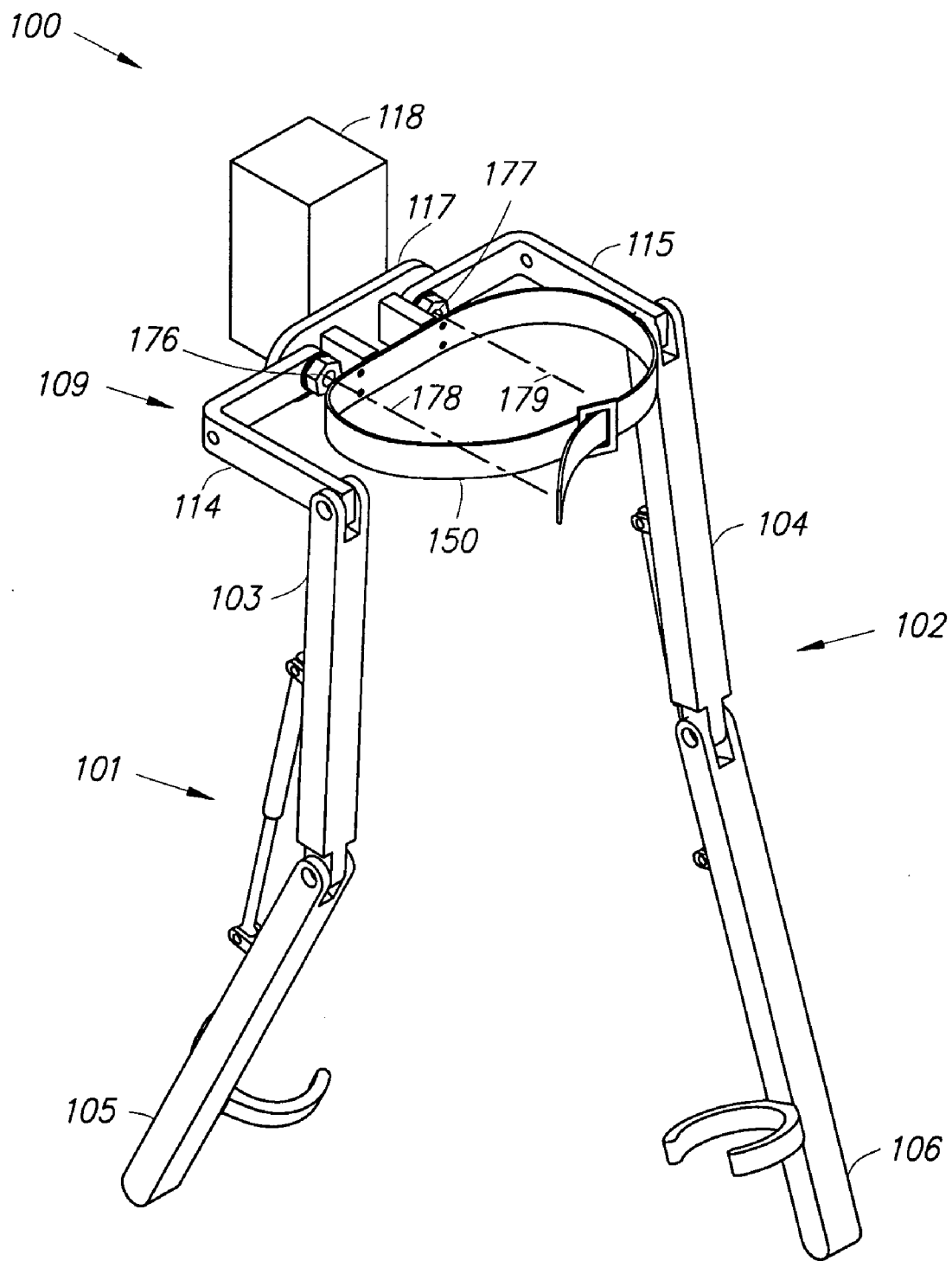

Fig. 5

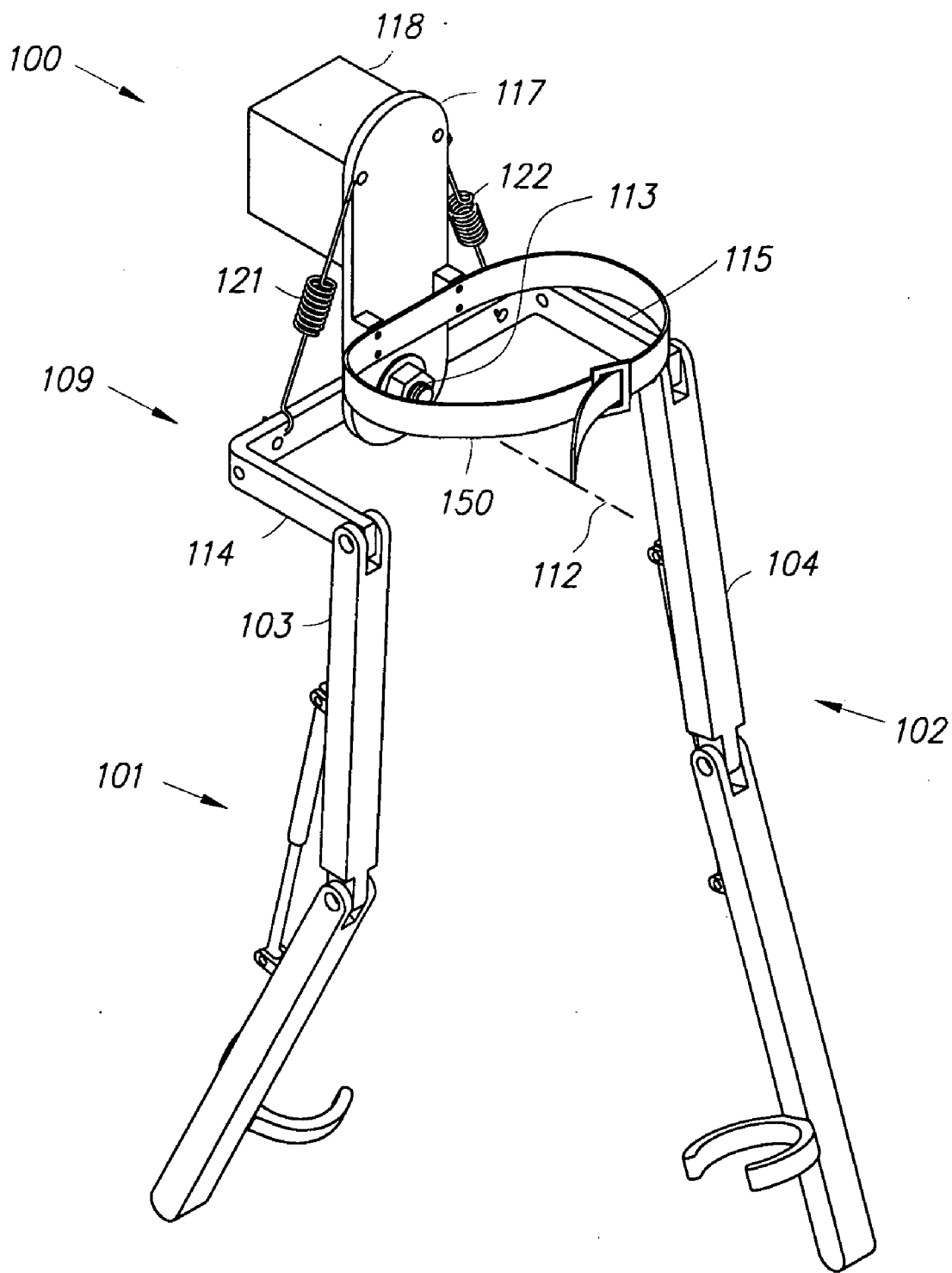

Fig. 6

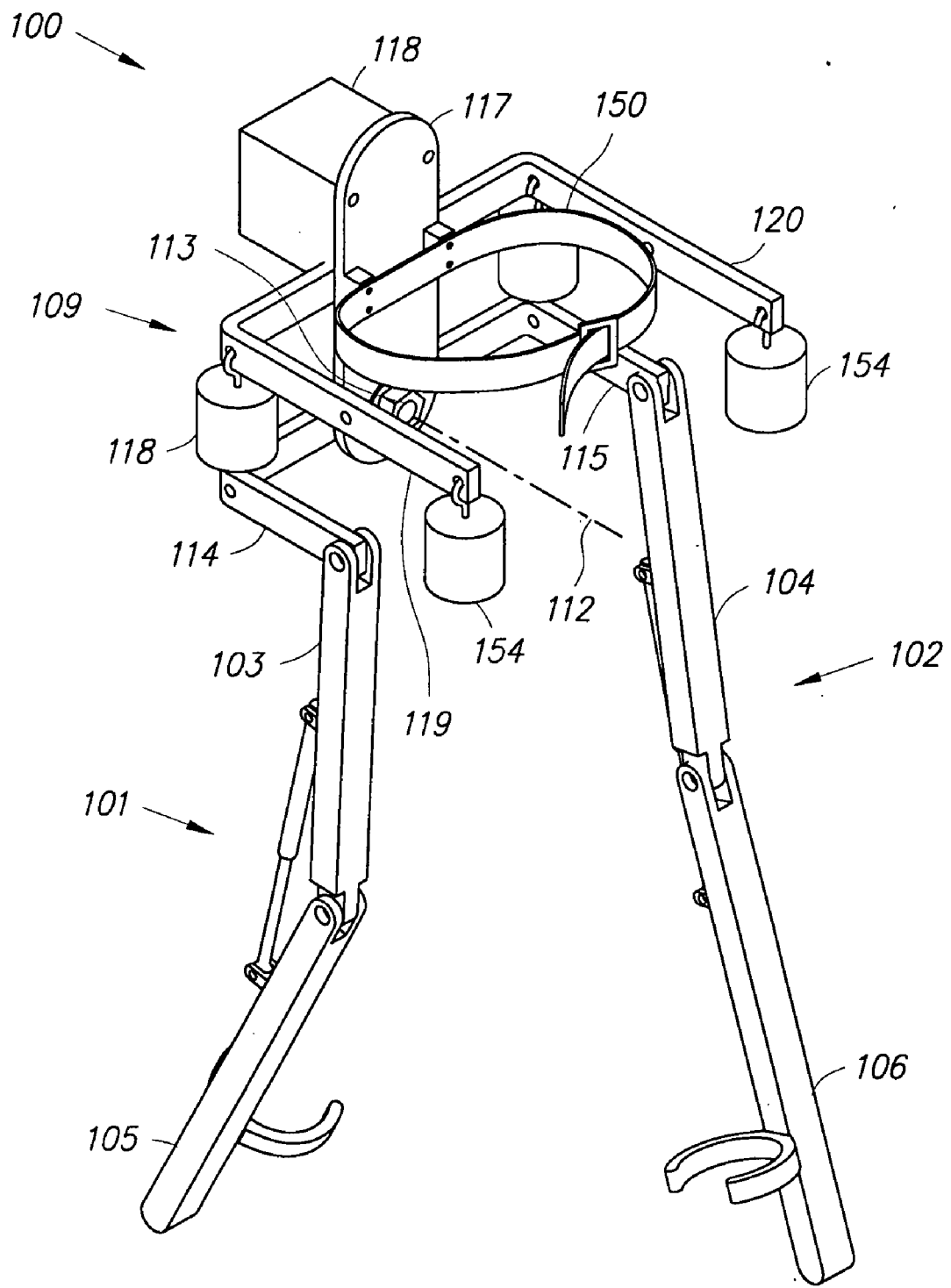

Fig. 7



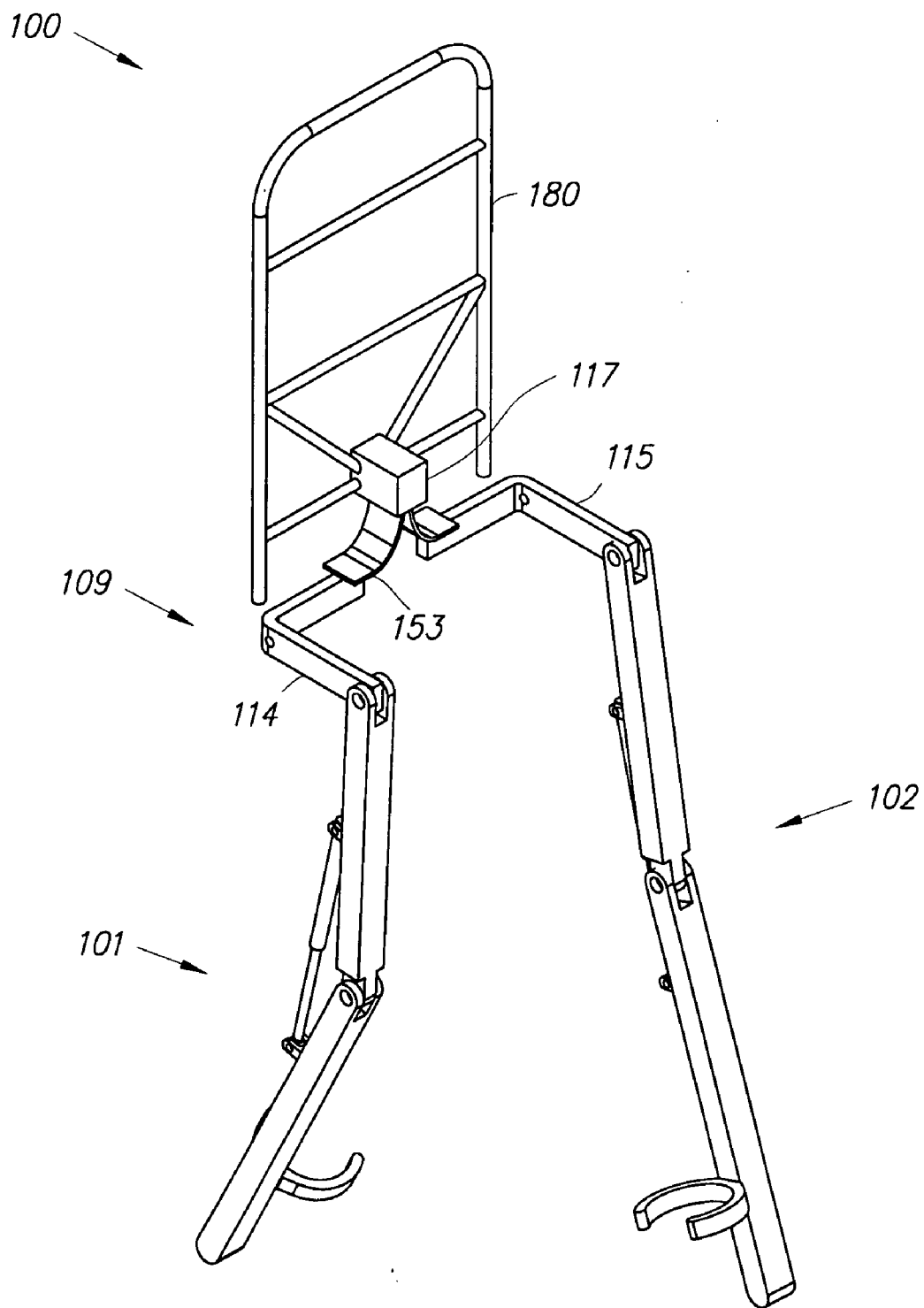

Fig. 8

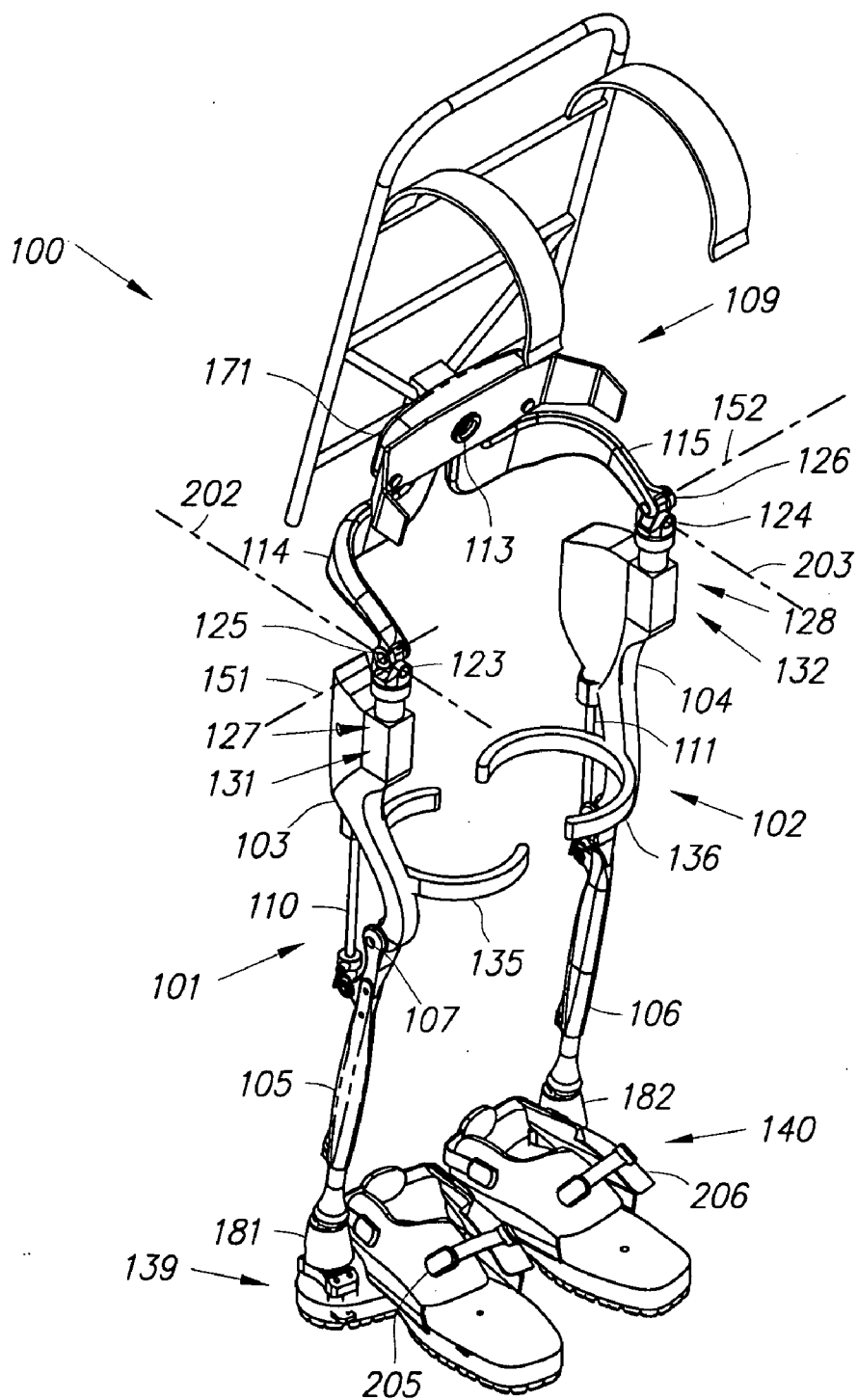

Fig. 9

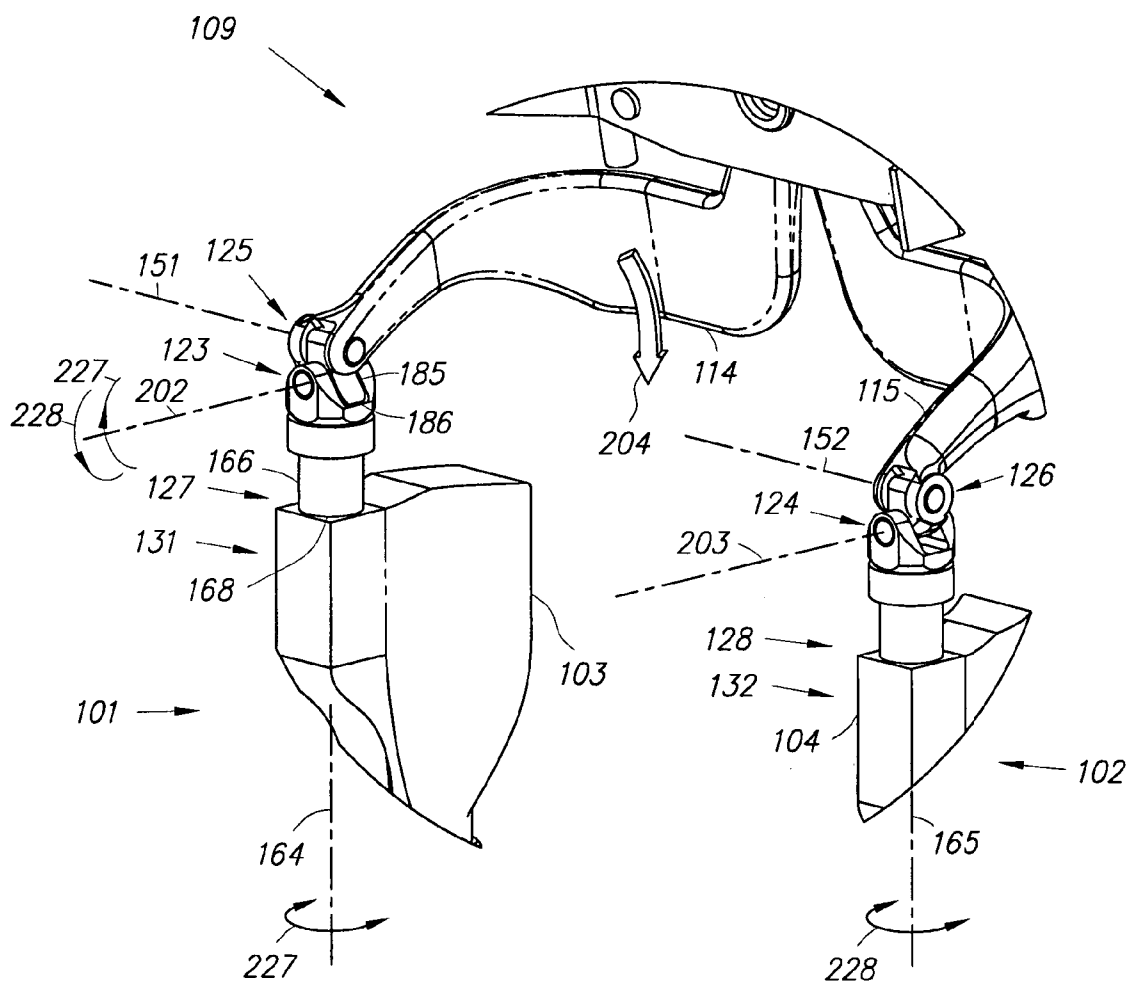

Fig. 10

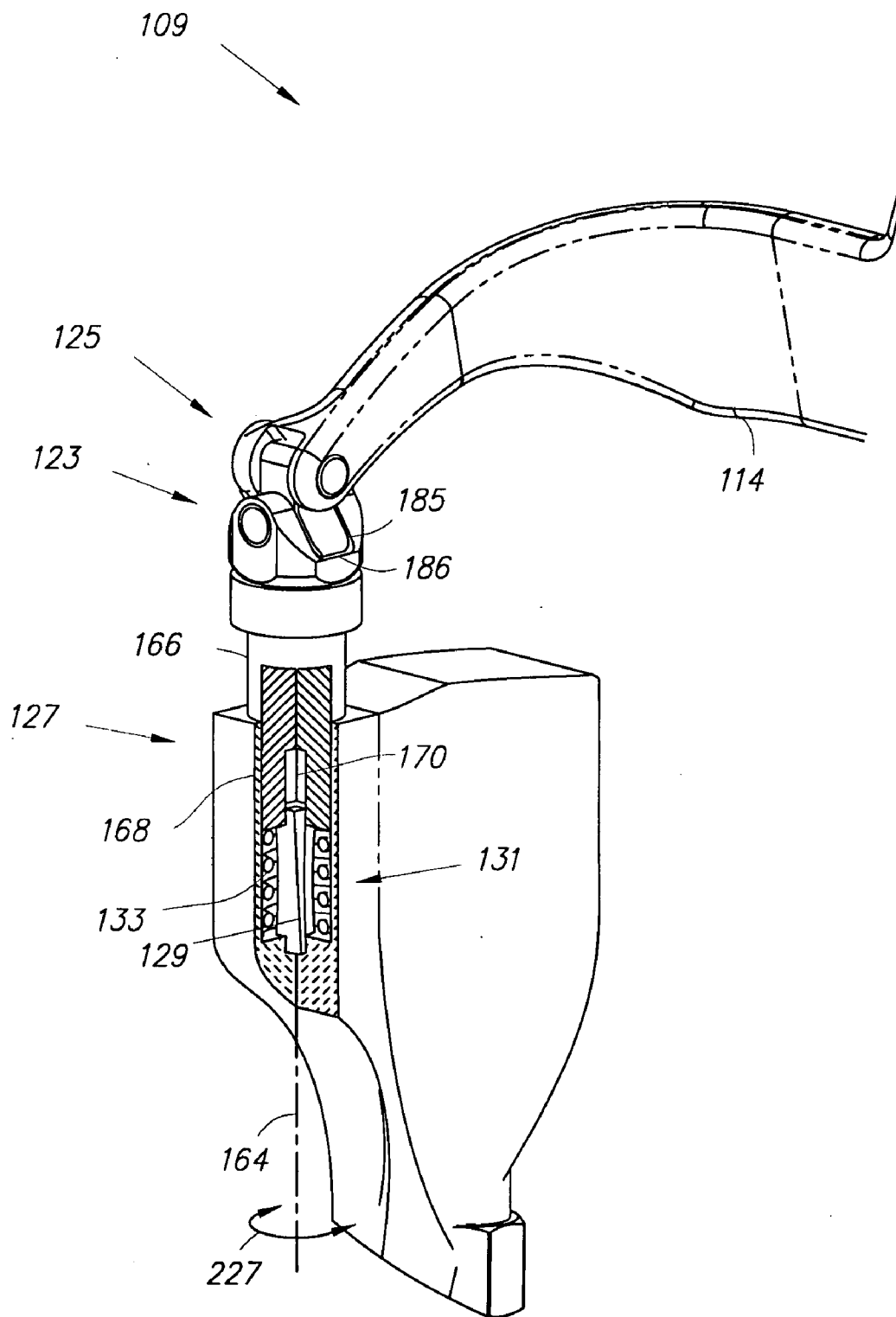

Fig. 11

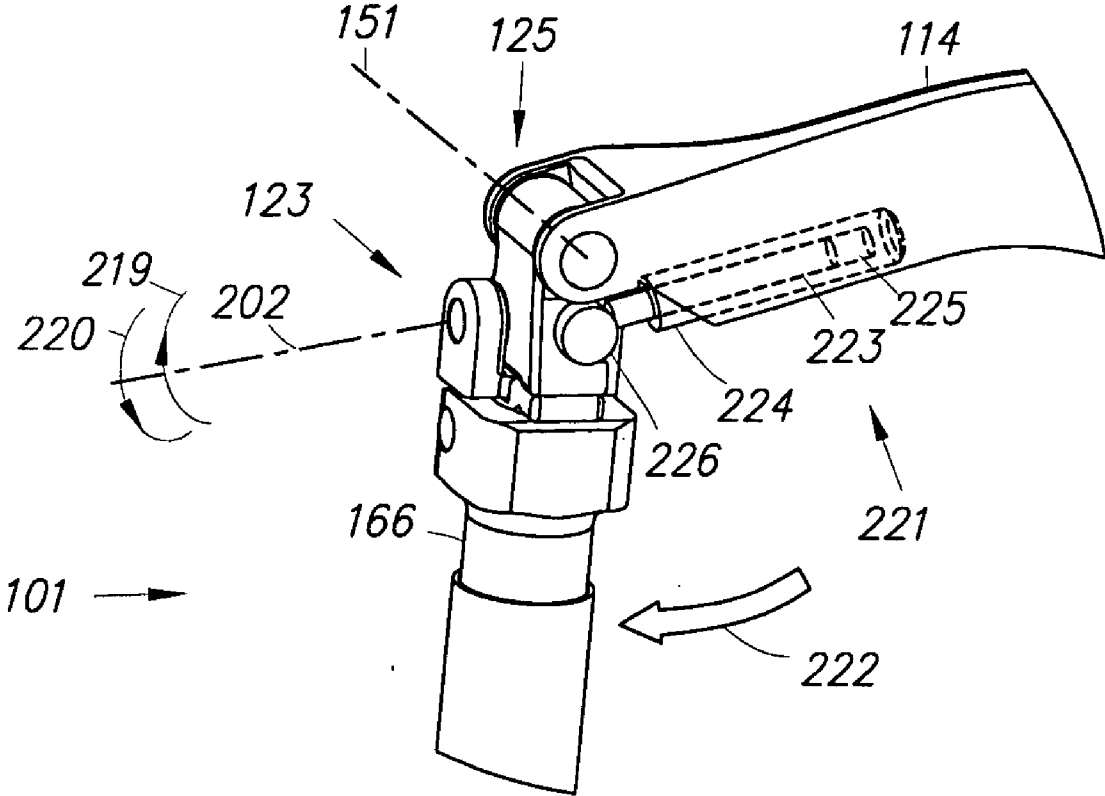

Fig. 12

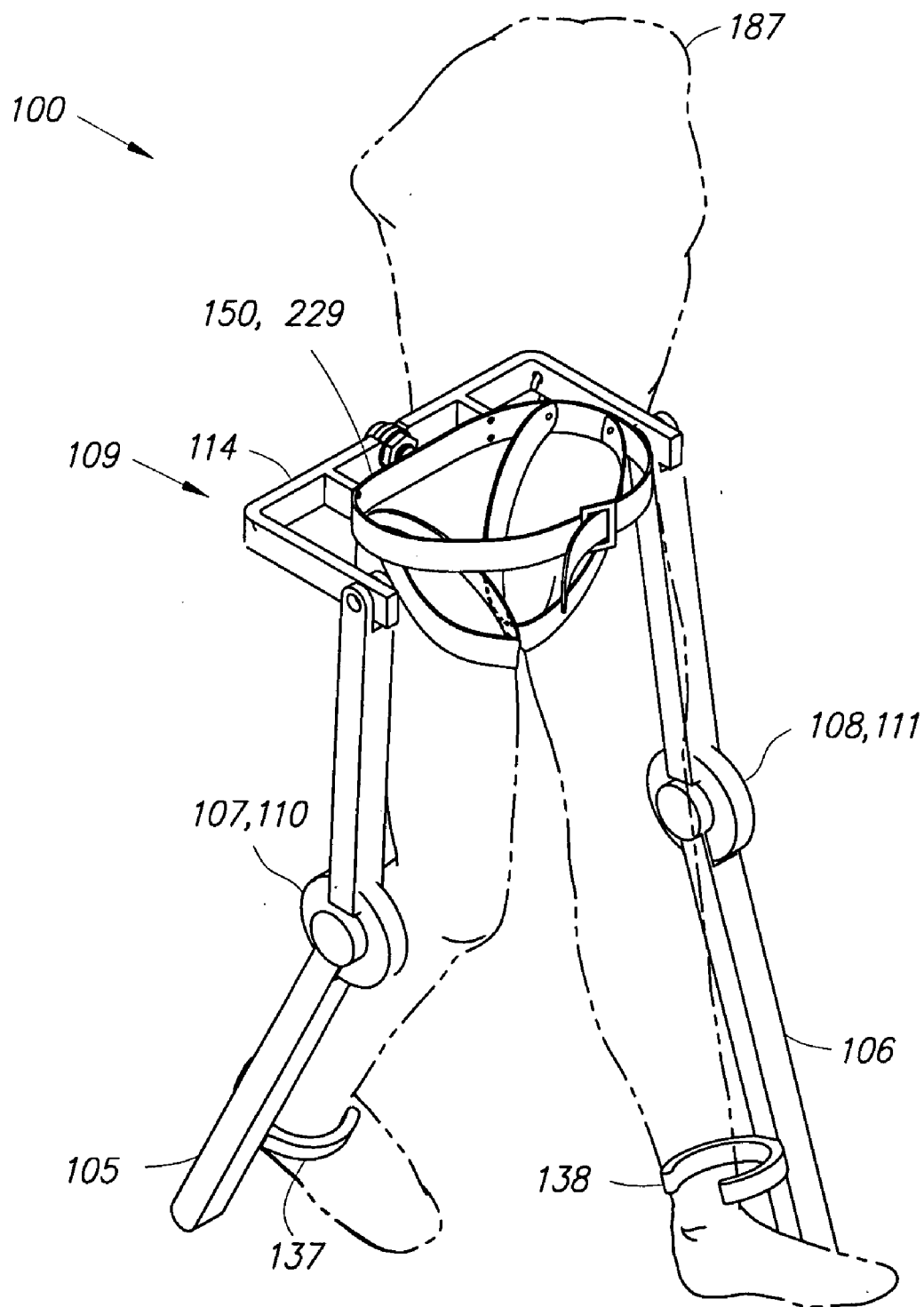

Fig. 13

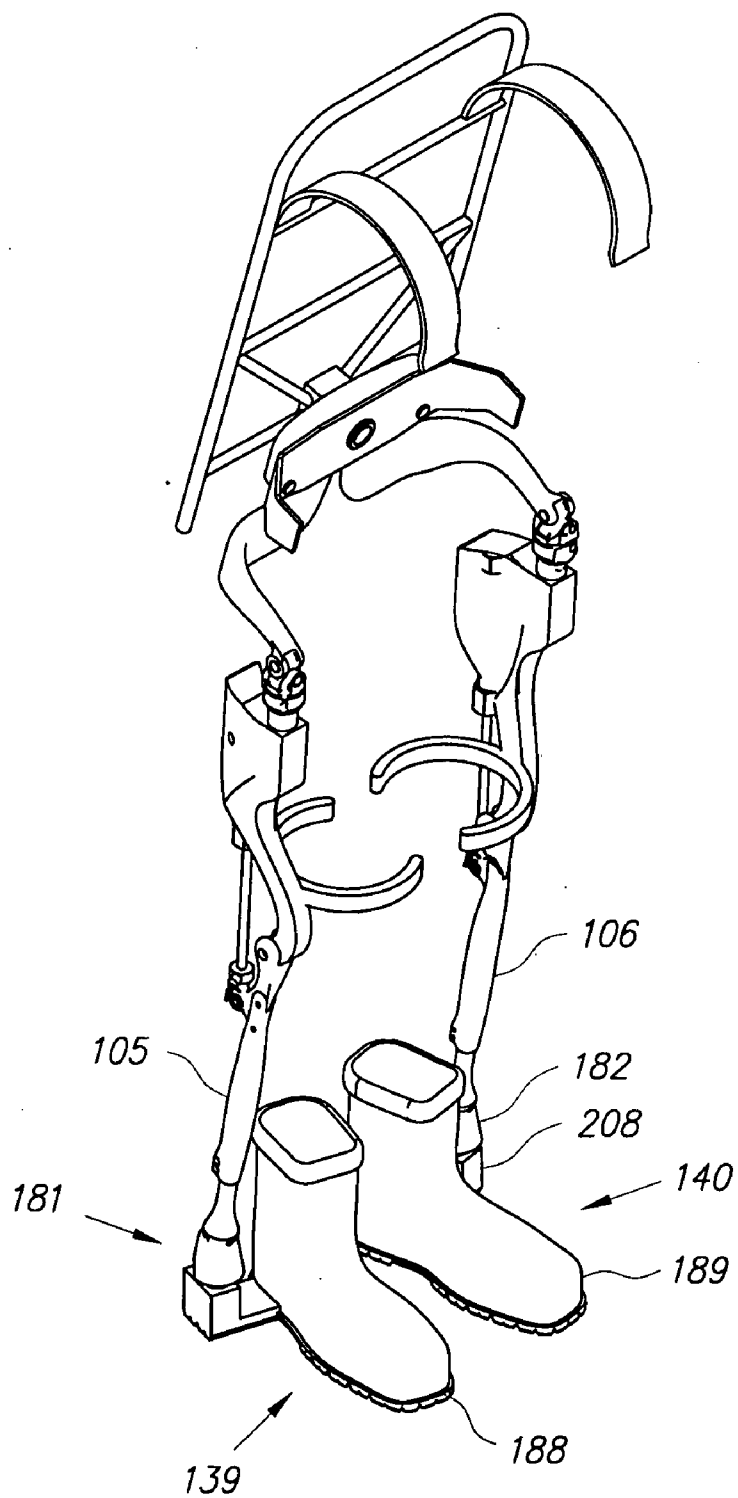

Fig. 14

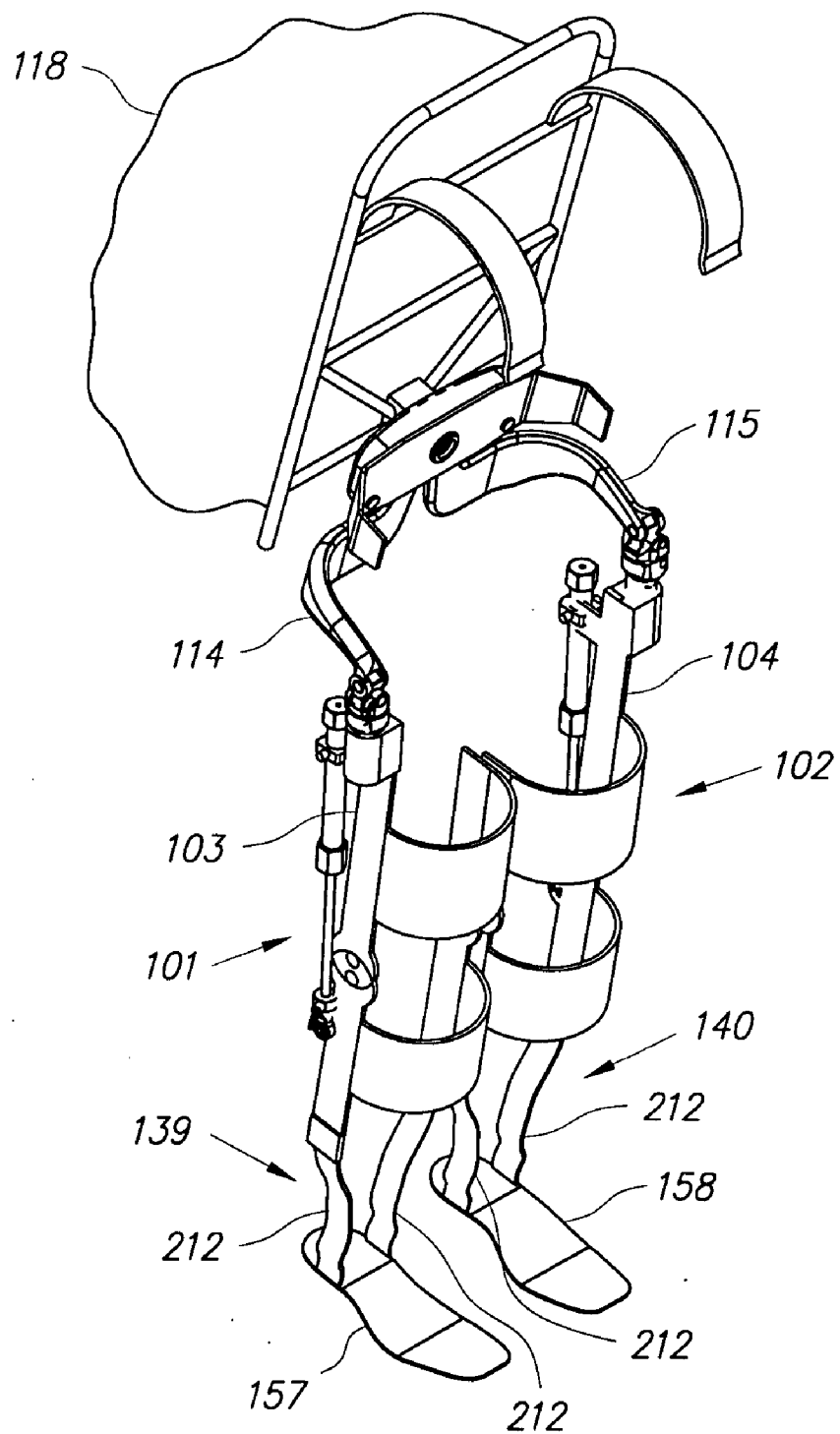

Fig. 15



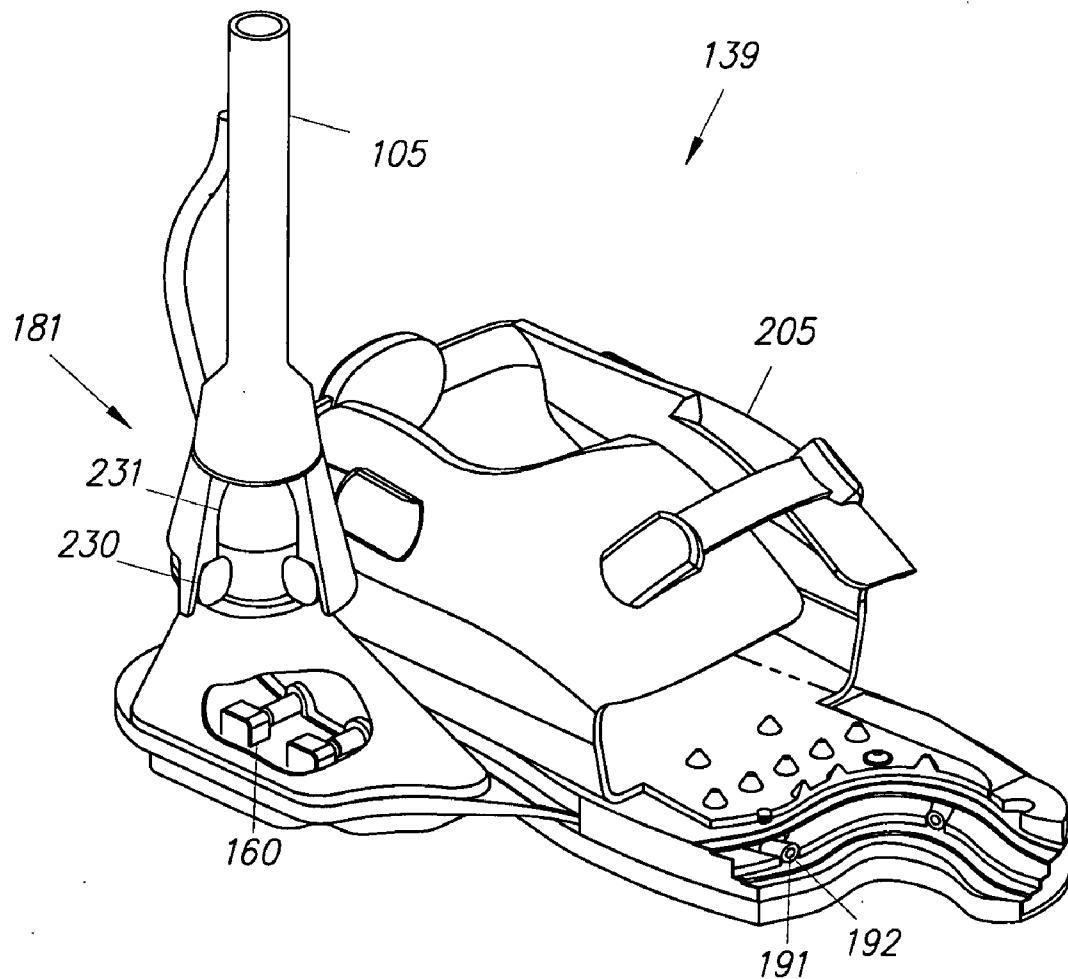

Fig. 16

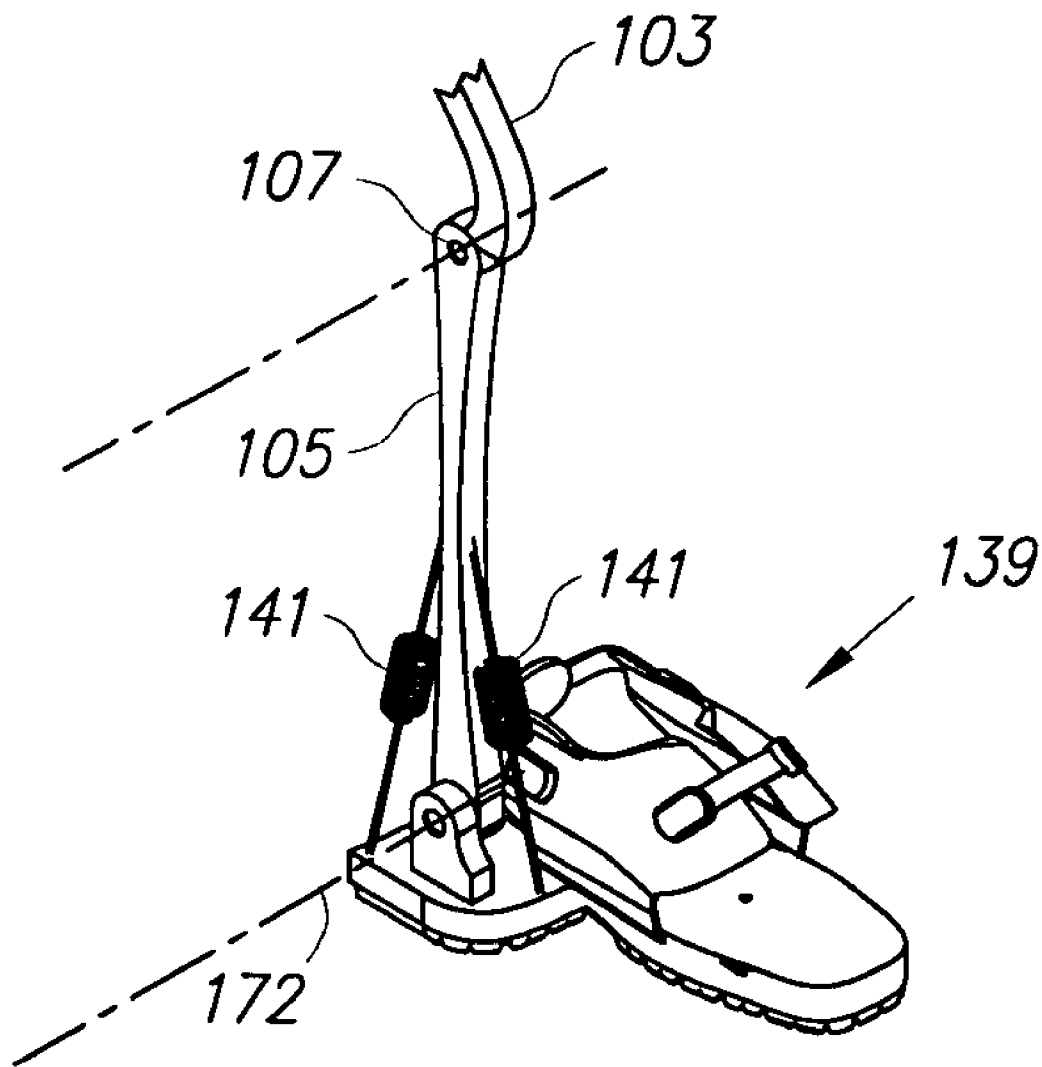

Fig. 17

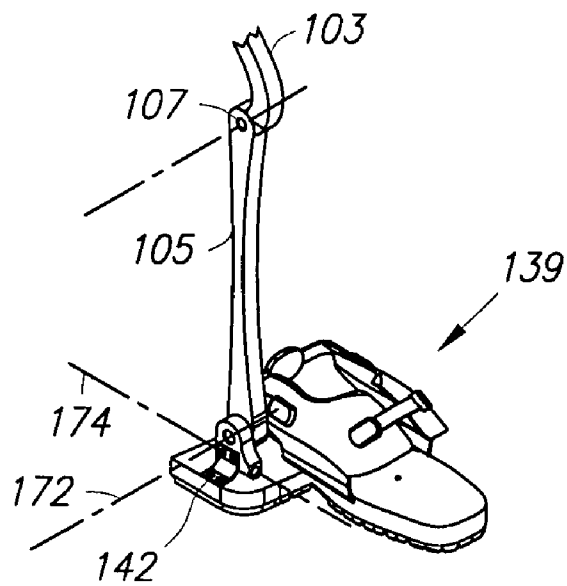

Fig. 18

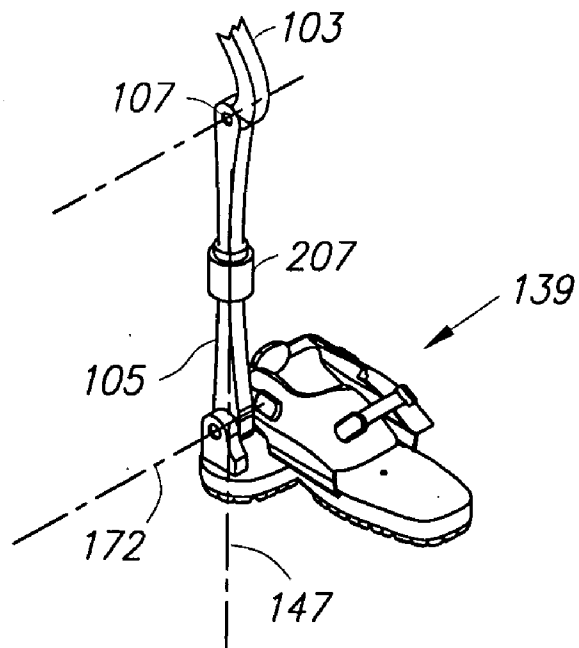

Fig. 19

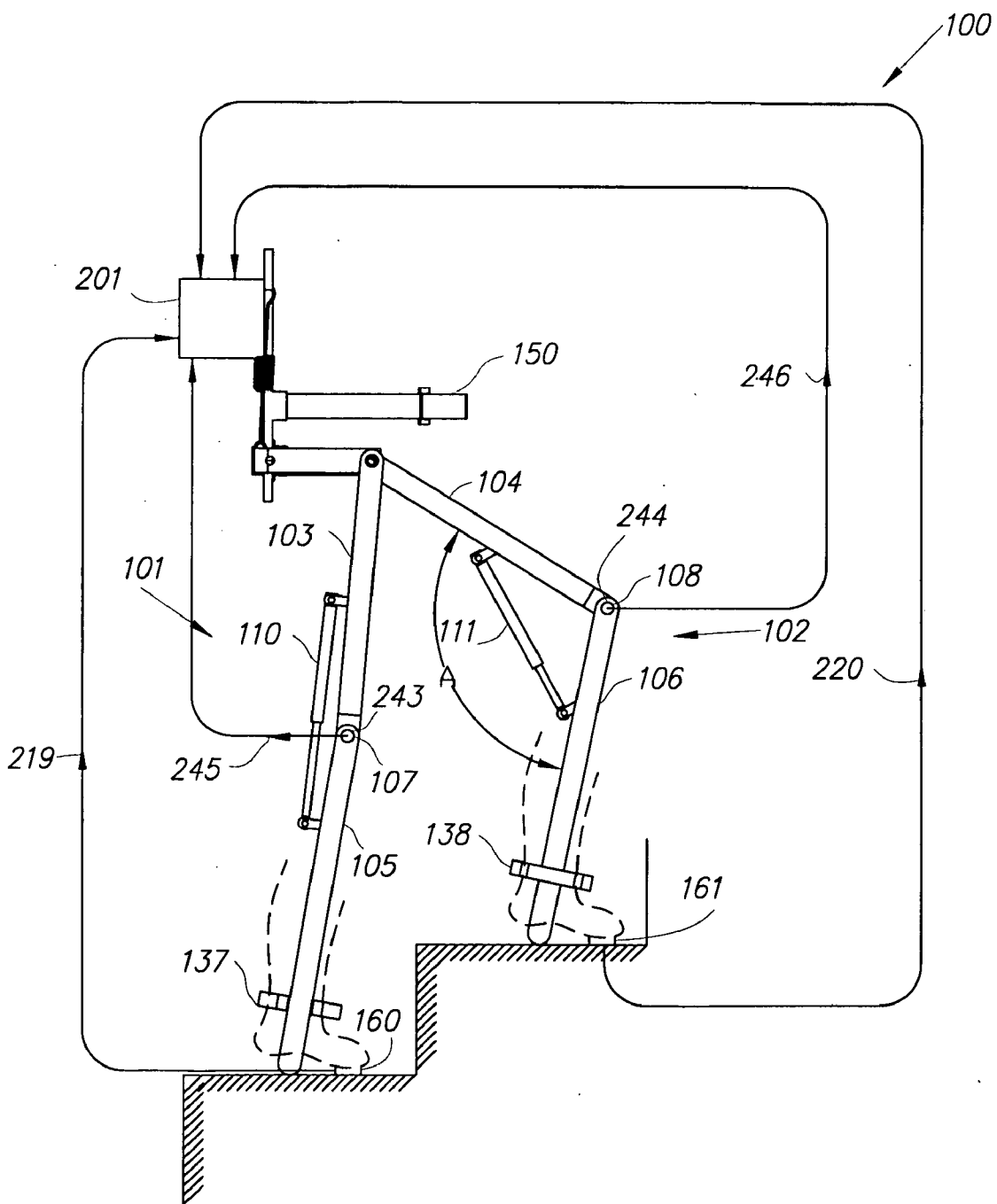

Fig. 20

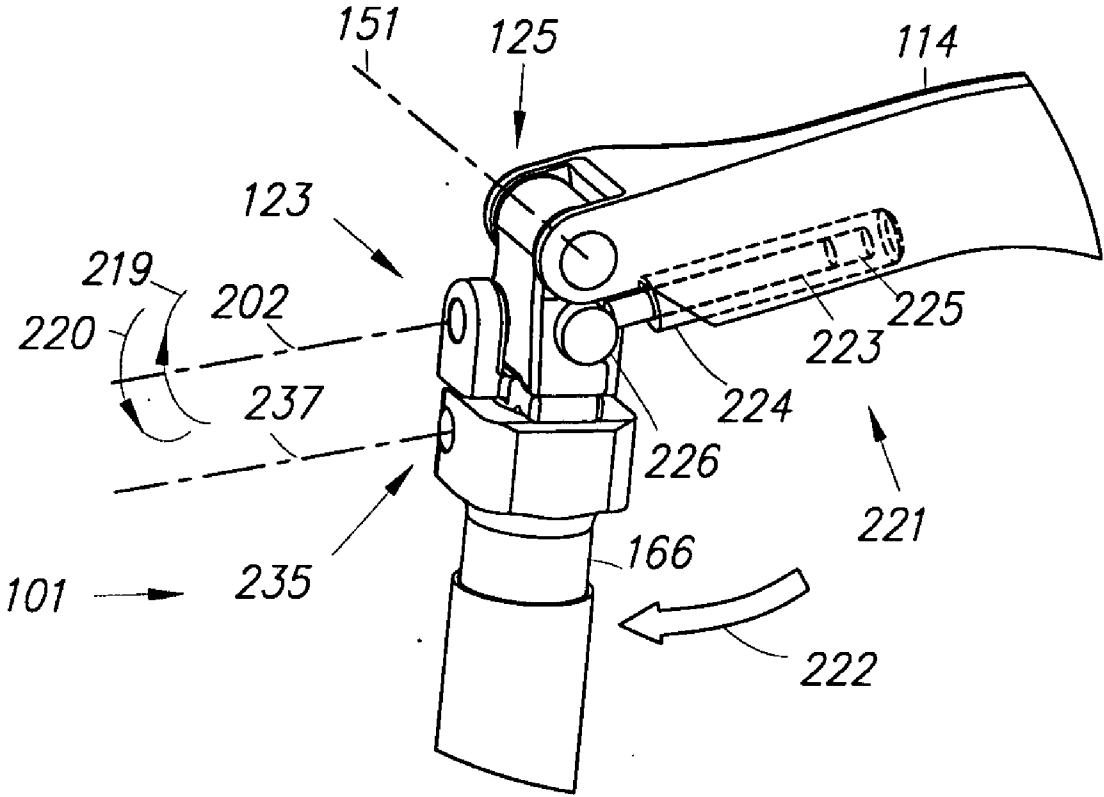

Fig. 21

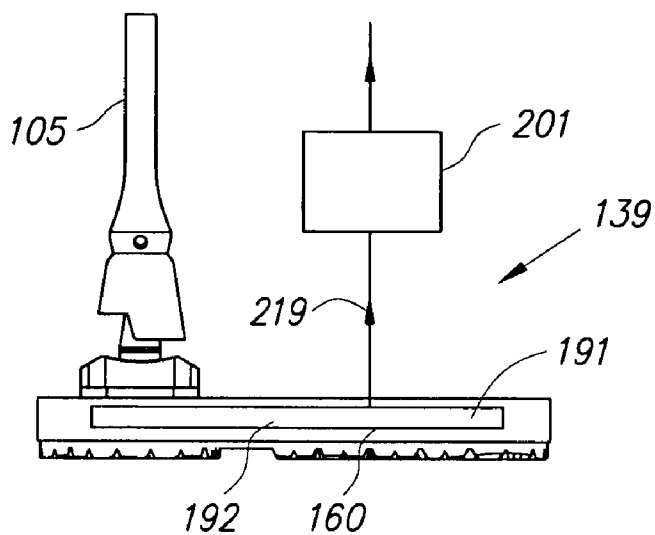

Fig. 22

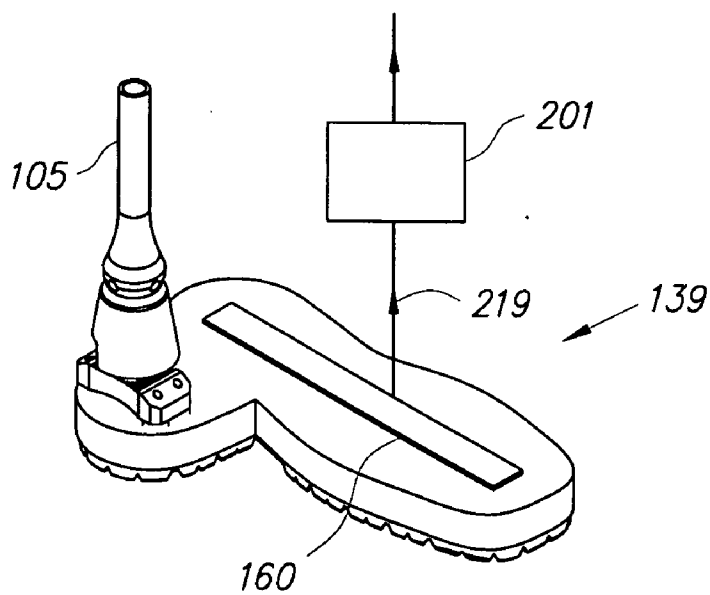

Fig. 23

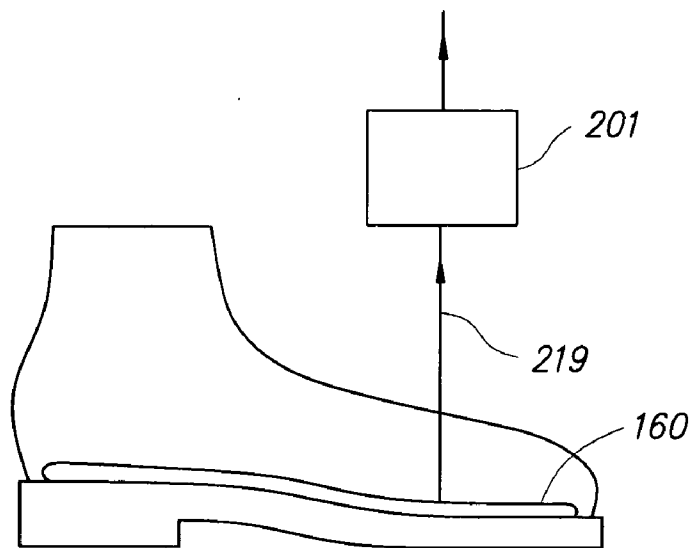

Fig. 24

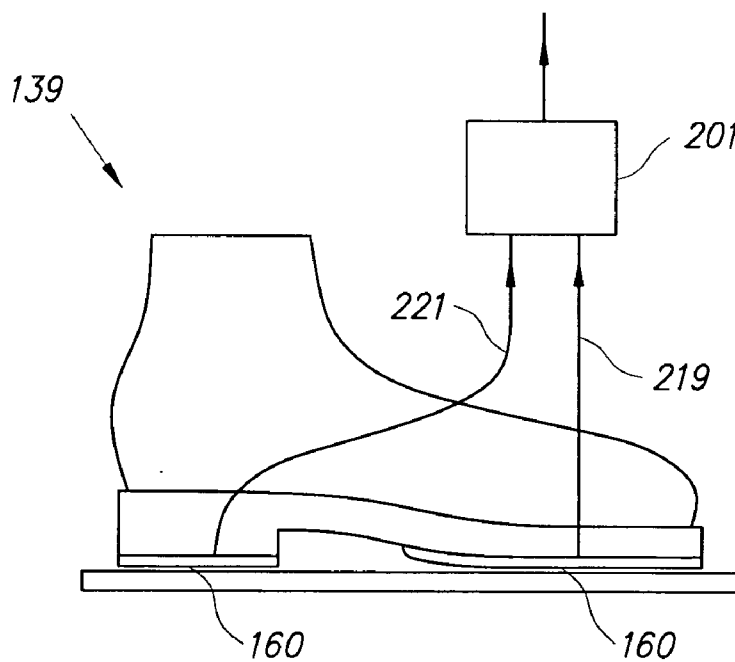
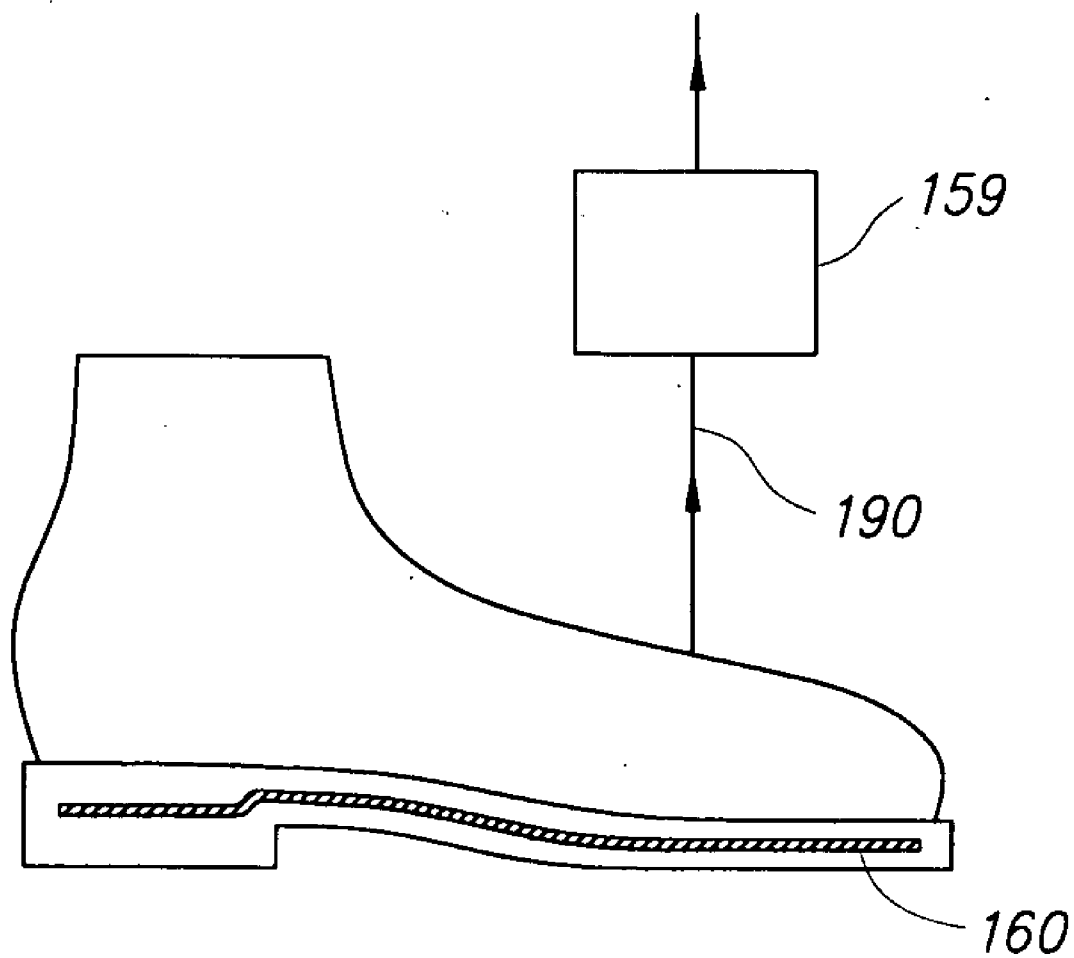

Fig. 25



*Fig. 26*



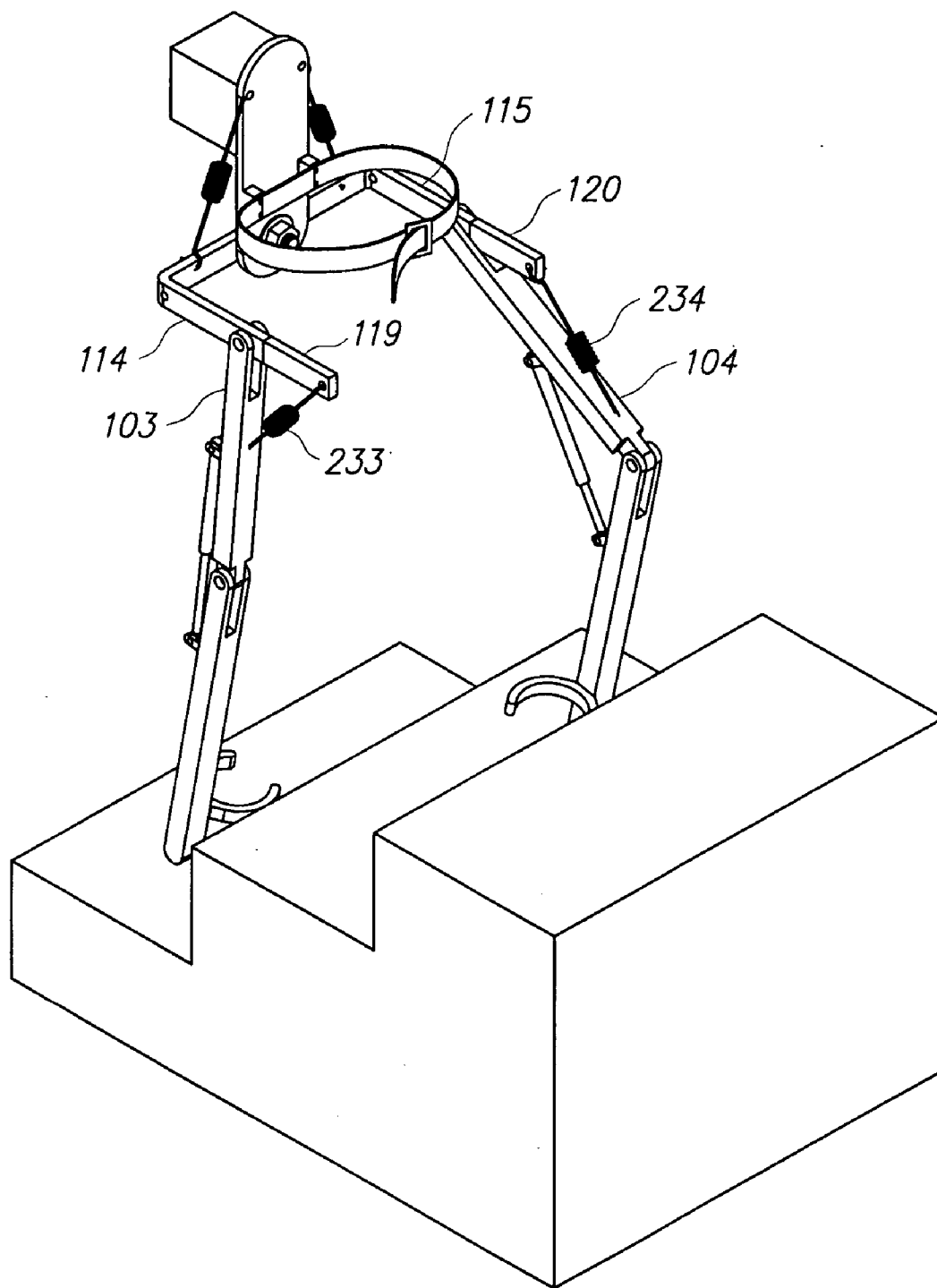

Fig. 27

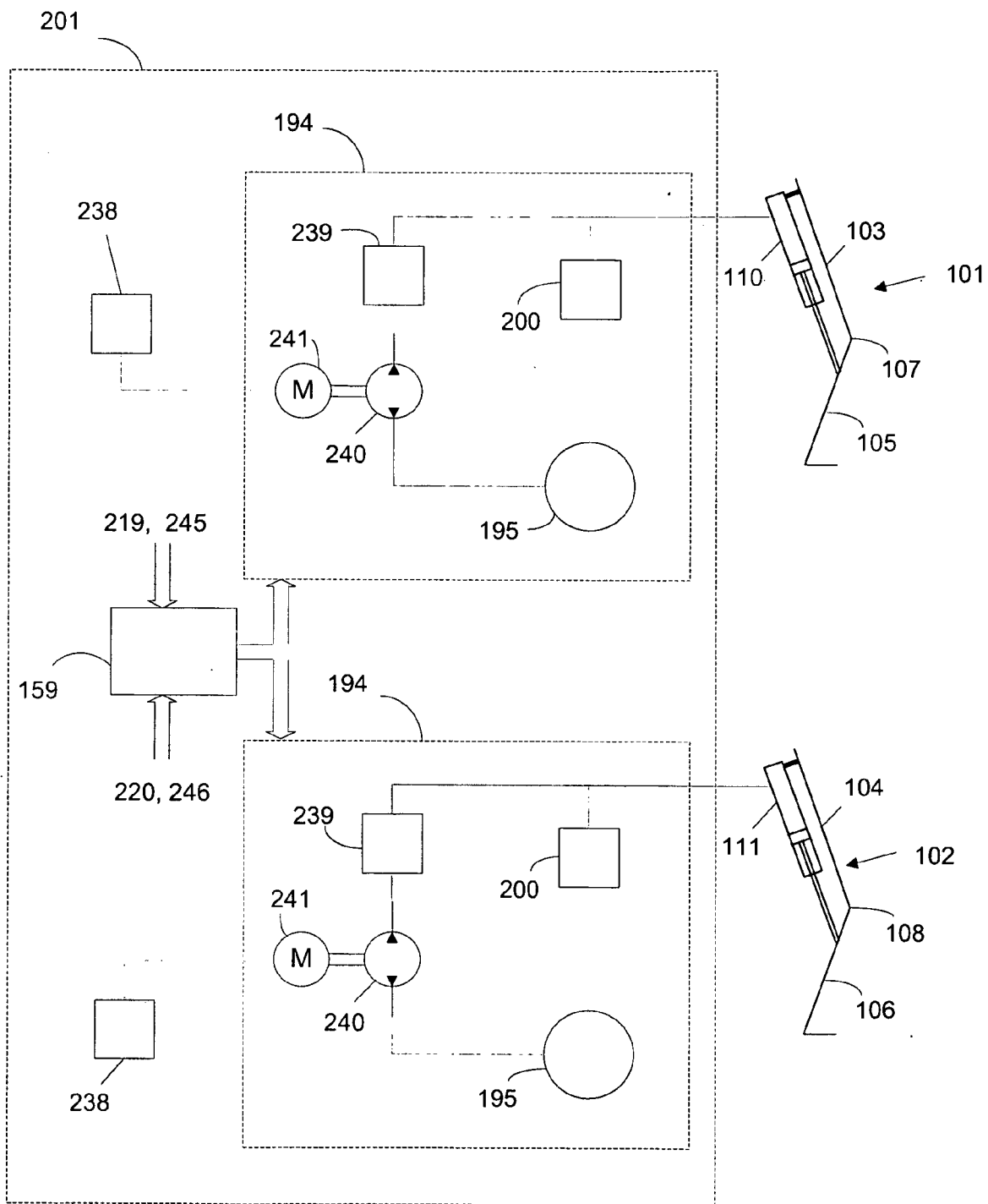

Figure 28

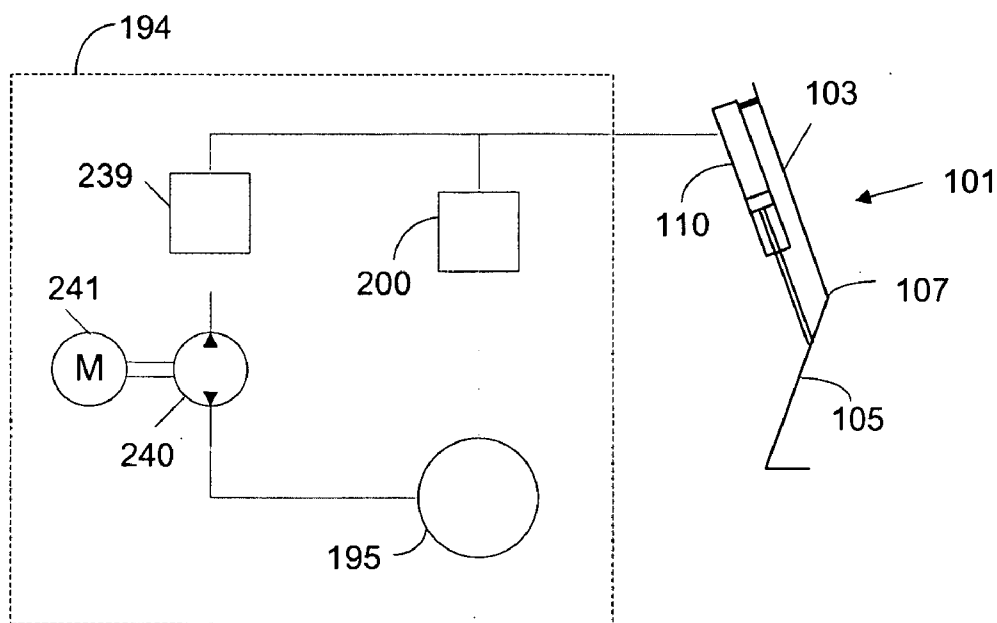

Figure 29

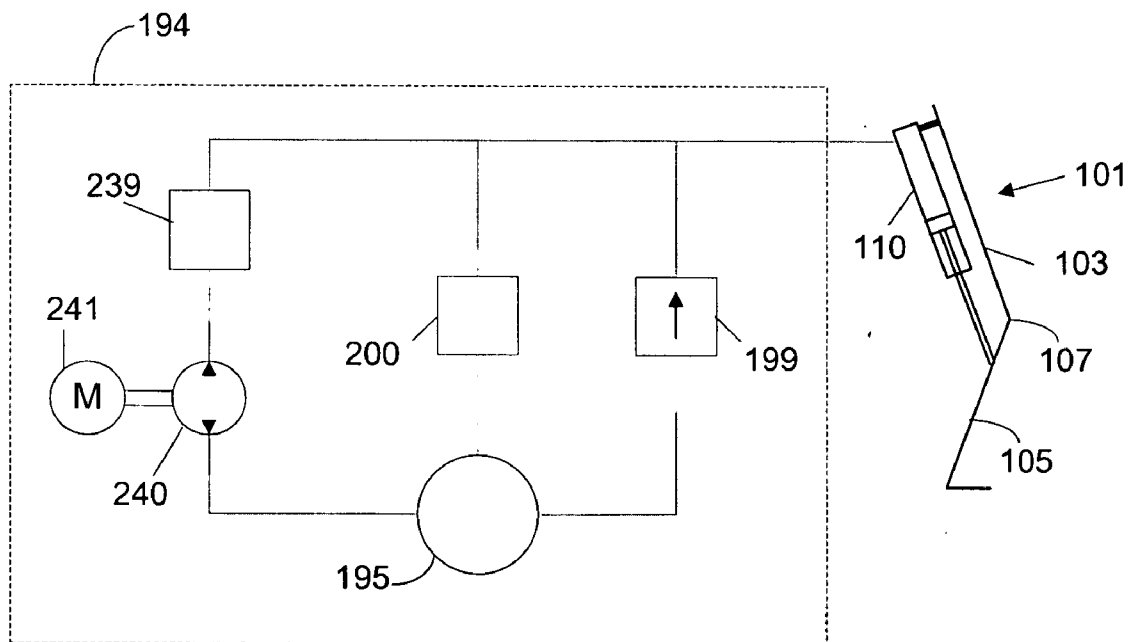

Figure 30

194

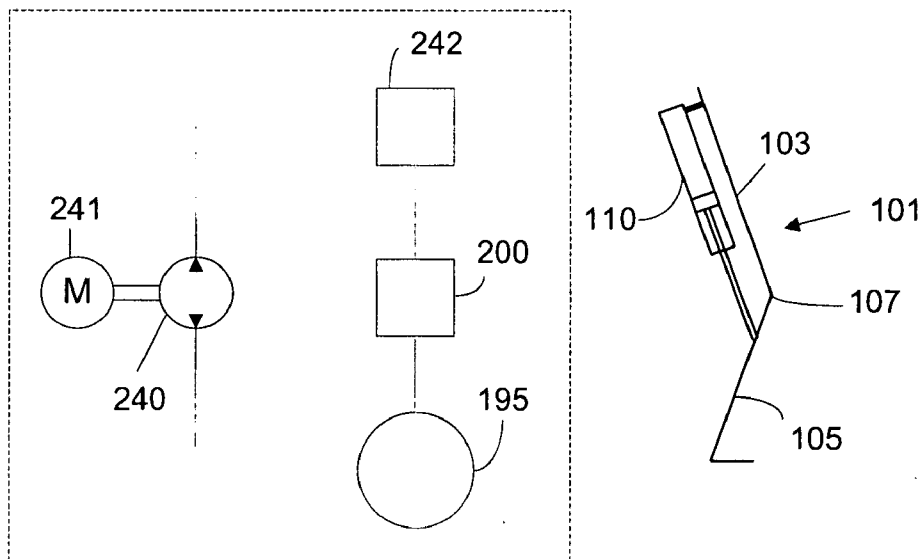

Figure 31

194

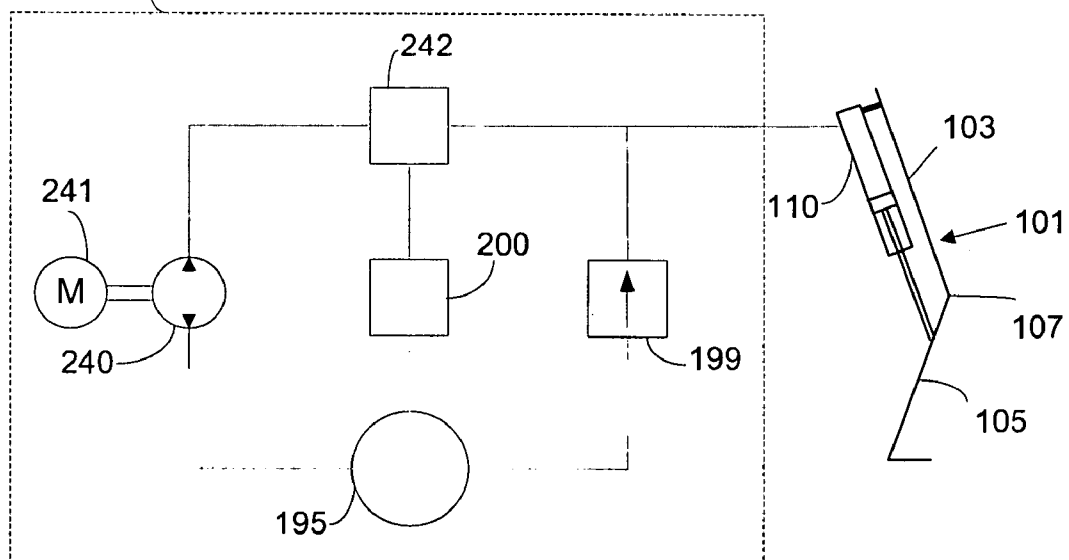

Figure 32

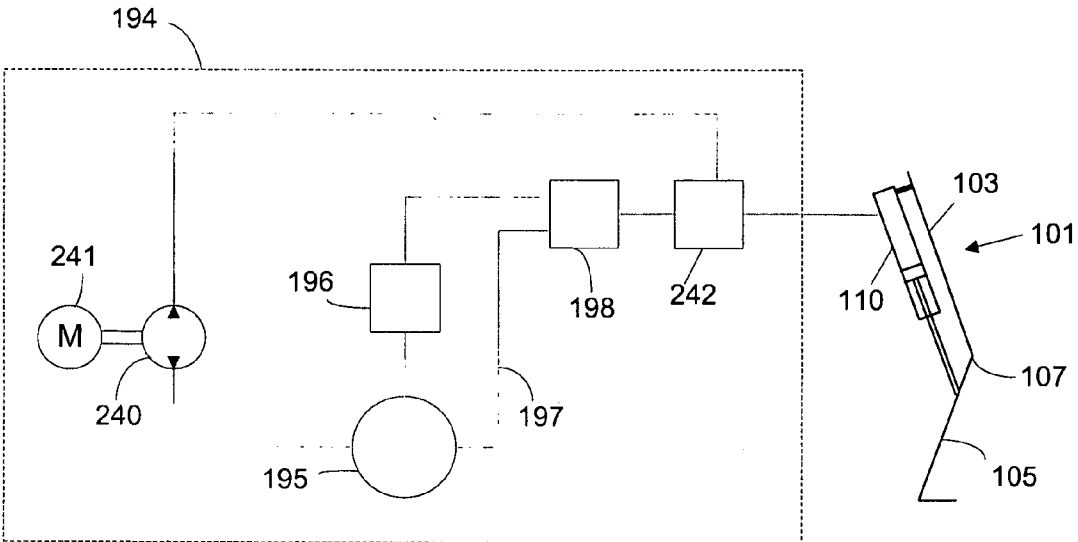

Figure 33

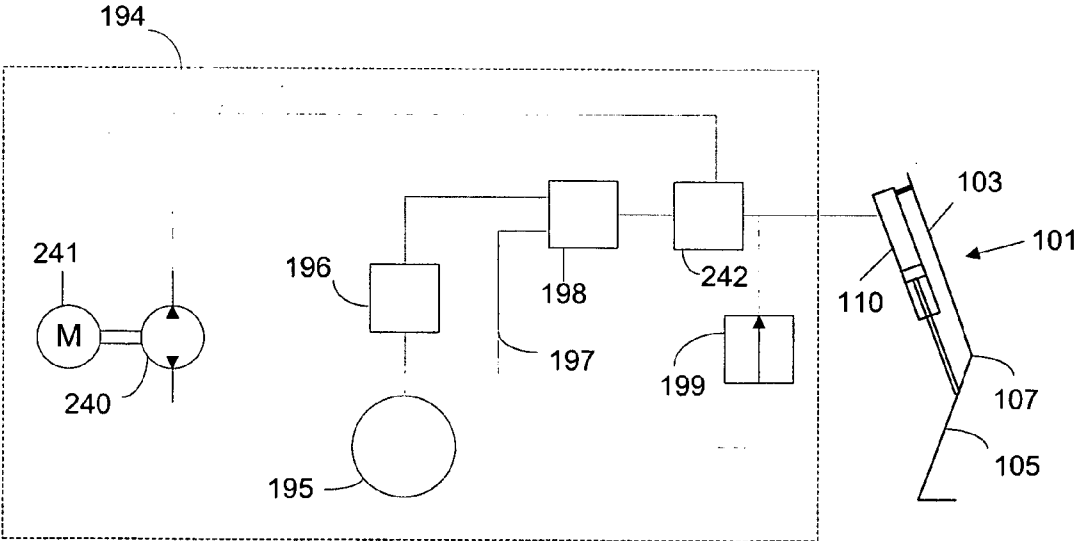

Figure 34

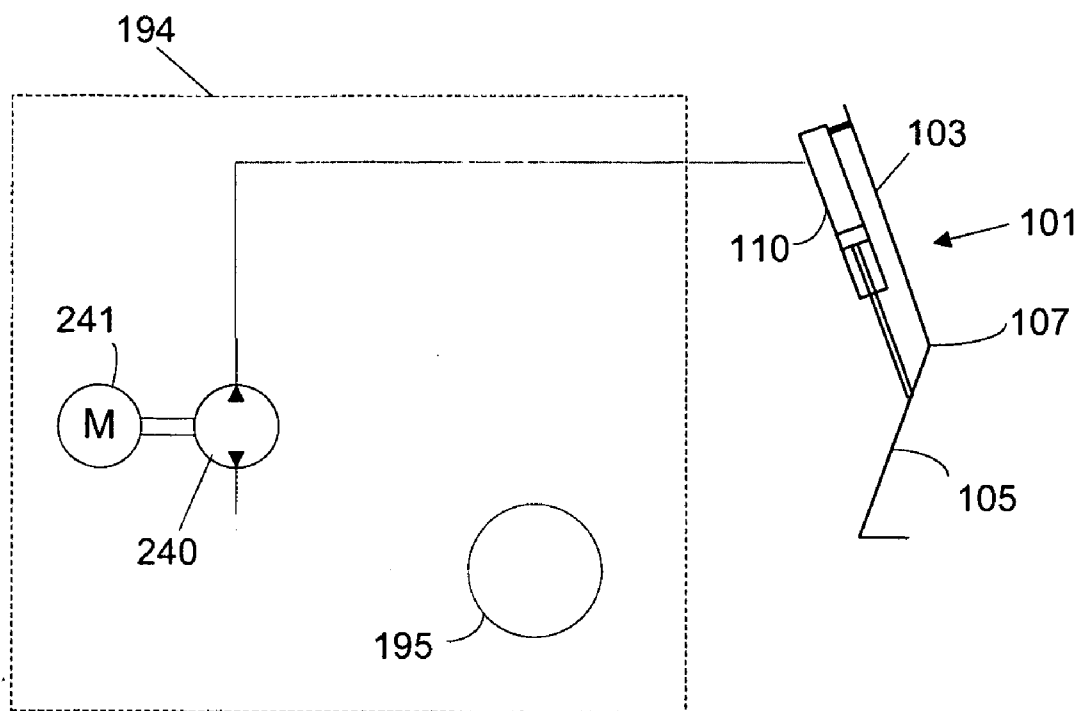

Figure 35

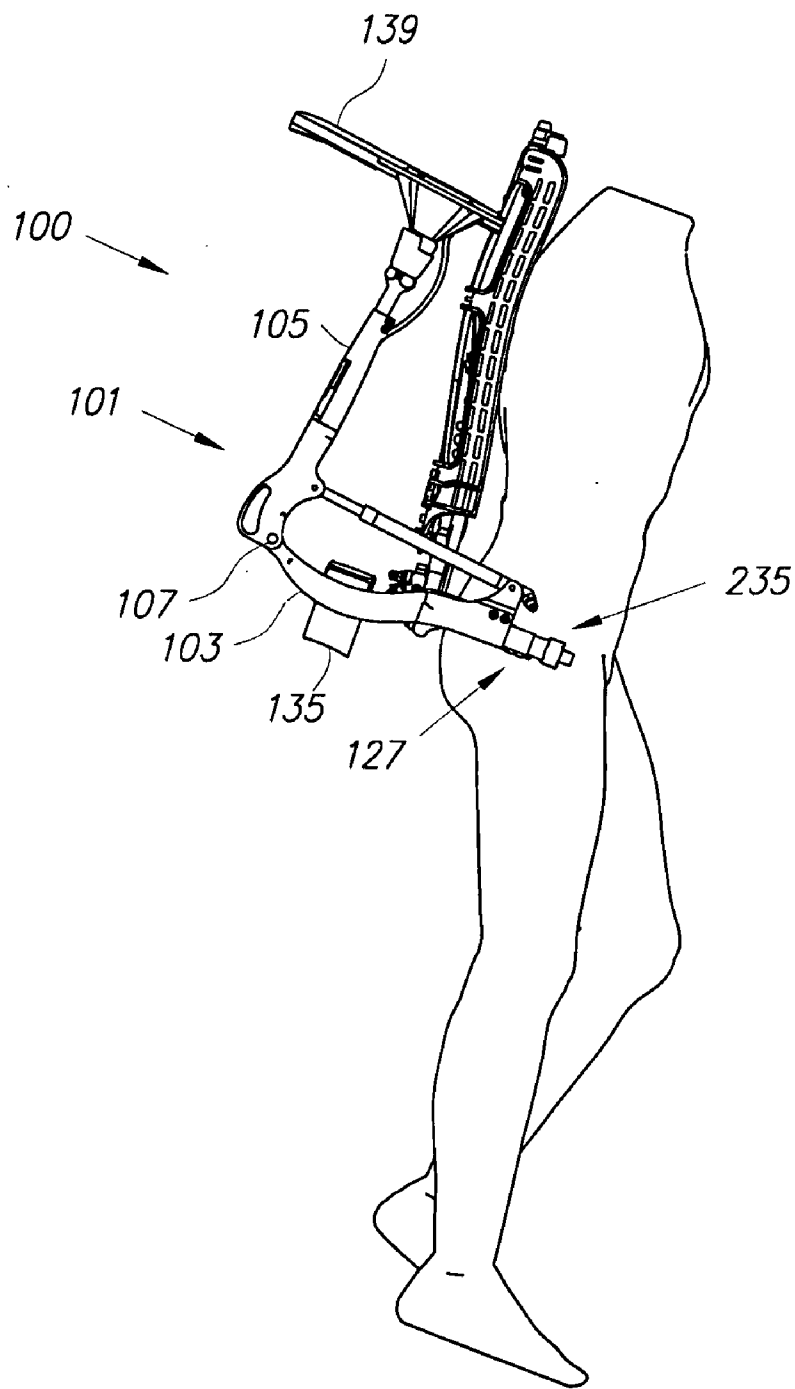

Fig. 36

**SEMI-POWERED LOWER EXTREMITY EXOSKELETON**

**CROSS-REFERENCE TO RELATED APPLICATIONS**

[0001] This application claims the benefit of U.S. Provisional Application No. 60/671,348, titled SEMI-POWERED LOWER EXTREMITY EXOSKELETON, filed Apr. 13, 2005, the entire content of which is incorporated herein by reference.

**STATEMENT REGARDING FEDERALLY SPONSORED RESEARCH OR DEVELOPMENT**

[0002] This invention was made with government support under Contract No. DAAD19-01-1-0509 awarded by Defense Advanced Research Projects Agency (DARPA). The government has certain rights in the invention.

**BACKGROUND**

[0003] 1. Field

[0004] The present invention relates generally to the field of lower extremity exoskeletons and more specifically to the field of semi-powered lower extremity exoskeletons.

[0005] 2. Related Art

[0006] In a wide variety of situations, people of ordinary ability are often frustrated in attempting to carry excessively heavy or bulky objects while walking on slopes and stairs. Some people cannot even carry their own weights without becoming tired quickly or injured. Opportunities exist, therefore, to provide a compact, easy-to-operate, fast, and general purpose device to carry load while the device is being worn by a person.

**SUMMARY**

[0007] The opportunities described above are addressed in several embodiments of a lower extremity exoskeleton, wearable by a person. The lower extremity exoskeleton comprises two leg supports connectable to person's lower limbs and configured to rest on the ground during their stance phase. Each leg support comprises a thigh link and a shank link; a knee joint configured to allow flexion and extension between the shank link and the thigh link. The lower extremity exoskeleton further comprises an exoskeleton trunk connectable to the person's upper body. The exoskeleton trunk is connectable to the thigh links of the leg supports allowing for the flexion and extension between the leg supports and the exoskeleton trunk. Two torque generators are coupled to each of the knee joints. A power unit, capable of providing power, is coupled to the torque generators. In operation when a leg support is in a stance phase and climbing a slope or stairs, the power unit injects power into the respective torque generator thereby extending the respective knee angle. When a leg support is in stance phase and not climbing a slope or stairs, the power unit does not inject any power to the respective torque generator, but without dissipating any stored power in said power unit, it forces the torque generator to resist flexion of the respective knee joint. When a leg support is in a swing phase, the power unit does not inject any power to the respective torque generator, but without dissipating any stored power in said

power unit, it forces the torque generator to minimize its resistance to knee flexion and extension.

**DRAWINGS**

[0008] These and other features, aspects, and advantages of the present invention will become better understood when the following detailed description is read with reference to the accompanying drawings in which like characters represent like parts throughout the drawings, wherein:

[0009] FIG. 1 is a front view perspective drawing in accordance with an embodiment of the present invention.

[0010] FIG. 2 is a rear view perspective drawing of the embodiment of FIG. 1.

[0011] FIG. 3 is a perspective drawing in accordance with an embodiment of the present invention.

[0012] FIG. 4 is a perspective drawing in accordance with an embodiment of the present invention.

[0013] FIG. 5 is a perspective drawing in accordance with an embodiment of the present invention.

[0014] FIG. 6 is a perspective drawing in accordance with an embodiment of the present invention.

[0015] FIG. 7 is a perspective drawing in accordance with an embodiment of the present invention.

[0016] FIG. 8 is a perspective drawing in accordance with an embodiment of the present invention.

[0017] FIG. 9 is a perspective drawing in accordance with an embodiment of the present invention.

[0018] FIG. 10 is a partial view of the invention of the embodiment of FIG. 9.

[0019] FIG. 11 is a partial view of the invention of the embodiment of FIG. 9.

[0020] FIG. 12 is a perspective drawing in accordance with an embodiment of the present invention.

[0021] FIG. 13 is a perspective drawing in accordance with an embodiment of the invention.

[0022] FIG. 14 is a perspective drawing in accordance with an embodiment of the exoskeleton foot.

[0023] FIG. 15 is a perspective drawing in accordance with an embodiment of the exoskeleton foot.

[0024] FIG. 16 is a perspective drawing in accordance with an embodiment of the exoskeleton foot.

[0025] FIG. 17 is a perspective drawing in accordance with an embodiment of the exoskeleton foot.

[0026] FIG. 18 is a perspective drawing in accordance with an embodiment of the exoskeleton foot.

[0027] FIG. 19 is a perspective drawing in accordance with an embodiment of the exoskeleton foot.

[0028] FIG. 20 is a drawing in accordance with an embodiment of the invention.

[0029] FIG. 21 is a perspective drawing in accordance with an embodiment of the invention.

[0030] FIG. 22 is a drawing in accordance with an embodiment of the exoskeleton foot.



[0031] FIG. 23 is a drawing in accordance with an embodiment of the exoskeleton foot.

[0032] FIG. 24 is a drawing in accordance with an embodiment of the exoskeleton foot.

[0033] FIG. 25 is a drawing in accordance with an embodiment of the exoskeleton foot.

[0034] FIG. 26 is a drawing in accordance with an embodiment of the exoskeleton foot.

[0035] FIG. 27 is a perspective drawing in accordance with an embodiment of the invention.

[0036] FIG. 28 is a drawing representing an embodiment of the exoskeleton power unit.

[0037] FIG. 29 is a drawing representing an embodiment of the exoskeleton hydraulic circuitry.

[0038] FIG. 30 is a drawing representing an embodiment of the exoskeleton hydraulic circuitry.

[0039] FIG. 31 is a drawing representing an embodiment of the exoskeleton hydraulic circuitry.

[0040] FIG. 32 is a drawing representing an embodiment of the exoskeleton hydraulic circuitry.

[0041] FIG. 33 is a drawing representing an embodiment of the exoskeleton hydraulic circuitry.

[0042] FIG. 34 is a drawing representing an embodiment of the exoskeleton hydraulic circuitry.

[0043] FIG. 35 is a drawing representing an embodiment of the exoskeleton hydraulic circuitry.

[0044] FIG. 36 is a drawing representing an embodiment of the exoskeleton stowed in a vertical position when the exoskeleton is not in use but needs to be carried.

#### DETAILED DESCRIPTION

[0045] In accordance with an embodiment of the present invention, FIG. 1 and FIG. 2 are perspective drawings illustrating a lower extremity exoskeleton 100 wearable by a person 187. Lower extremity exoskeleton 100 comprises two leg supports 101 and 102, which are configured to be connectable to the person's lower limbs and configured to rest on the ground during their stance phase. The leg supports comprise thigh links 103 and 104 and shank links 105 and 106. Two knee joints 107 and 108 are configured to allow flexion and extension between the shank and thigh of the leg supports (shown by arrows 213 and 214 respectively). Lower extremity exoskeleton 100 further comprises an exoskeleton trunk 109. Exoskeleton trunk 109, among other components, comprises a human interface device 150. Exoskeleton trunk 109 is configurable to be coupled to the person's upper body through human interface device 150. The person's upper body means any location above the thighs. Exoskeleton trunk 109 is rotatably connectable to thigh links 103 and 104 of leg supports 101 and 102 at hip flexion-extension joints 125 and 126, allowing for the hip flexion and extension rotations (shown by arrows 215 and 216 respectively) of leg supports 101 and 102 about hip flexion-extension axes 151 and 152 respectively.

[0046] Two torque generators 110 and 111 are coupled to knee joints 107 and 108. A power unit 201, capable of providing power, is coupled to torque generators 110 and

111, and is configured to operate in at least two modes for each torque generator 110 and 111. In operation, when power unit 201 operates in its first mode with respect to torque generator 110, power unit 201 injects power into torque generator 110 to extend the knee angle of leg support 101, which is defined between shank link 105 and thigh link 103 of the leg support 101. When power unit 201 operates in its second mode with respect to torque generator 110, the energy required for the flexion and extension between shank link 105 and thigh link 103 of leg support 101 over a cyclic knee motion is provided by person 187 but power unit 201 causes torque generator 110 to resist flexion. The same operation is true for torque generator 111. When power unit 201 operates in its first mode with respect to torque generator 111, power unit 201 injects power into torque generator 111 to extend knee angle of leg support 102. When power unit 201 operates in its second mode with respect to torque generator 111, the energy required for the flexion and extension between shank link 106 and thigh link 104 of leg support 102 over a cyclic knee motion is provided by person 187 but power unit 201 causes torque generator 111 to resist flexion.

[0047] A cyclic knee motion here is defined as a motion where the initial and the final configurations of a shank link (105 or 106) and its corresponding thigh link (103 or 104) with respect to each other are nearly identical. In particular when a leg support is in a swing phase, a cyclic knee motion is a motion where the leg support is not in contact with the ground and the initial and the final configurations of the corresponding shank link and thigh link with respect to each other are nearly identical. Likewise, when a leg support is in a stance phase, a cyclic knee motion is a motion where the leg support is in contact with the ground and the initial and the final configurations of the corresponding shank link and thigh link with respect to each other are nearly identical.

[0048] In some embodiments, power unit 201 further operates in a third mode for each torque generators 110 and 111. In operation, when power unit 201 operates in its third mode with respect to torque generator 110, the energy required for the flexion and extension between shank link 105 and thigh link 103 of leg support 101 over a cyclic knee motion is provided by person 187, and power unit 201 causes torque generator 110 to minimize its resistance to knee flexion and extension. Similarly when power unit 201 operates in its third mode with respect to torque generator 111, the energy required for the flexion and extension between the shank link 106 and thigh link 104 of leg support 102 over a cyclic knee motion is provided by person 187, and power unit 201 causes torque generator 111 to minimize its resistance to knee flexion and extension.

[0049] In some embodiments, as shown in FIG. 1, lower extremity exoskeleton 100 comprises at least one foot sensor per leg support. Leg support 101 includes foot sensor 160, which produces a stance signal 219 representing the force on the bottom of wearer's corresponding foot. Similarly leg support 102 includes foot sensor 161, which produces a stance signal 220 representing the force on the bottom of the other wearer's foot. Power unit 201 controls torque generators 110 and 111 as a function of stance signals 219 and 220. Stance signals 219 and 220 detect if the wearer's leg is in stance phase or in a swing phase. In some embodiments of foot sensors, stance signals 219 and 220 represent the magnitude of the force on the bottom of wearer's feet.

During swing phase, stance signals **219** and **220** will detect small or zero magnitude for the force on the bottom of the wearer's feet.

[0050] In some embodiments, as shown in FIG. 20, lower extremity exoskeleton **100** includes at least one angle sensor per leg support. Leg support **101** comprises an angle sensor **243** which produces an angle signal **245** representing the angle of knee joint **107**. Similarly leg support **102** comprises an angle sensor **244** which produces an angle signal **246** representing the angle of knee joint **108**. Power unit **201** controls torque generators **110** and **111** as a function of angle signals **245** and **246**. Angle signals **245** and **246** detect if leg supports **101** and **102** are postured (i.e., bent) to climb stairs or a slope. In some embodiments of angle sensors, angle signals **245** and **246** represent the magnitude of the joint angles for knee joints **107** and **108**.

[0051] In some embodiments, power unit **201** operates in its first mode with respect to torque generator **110**, when stance signal **219** indicates the presence of a force on the bottom of corresponding human foot (i.e., leg support **101** is in a stance phase) and angle signal **245** indicates that leg support **101** is either bent or postured to climb stairs or a slope. The same is also true for torque generator **111**. Power unit **201** operates in its first mode with respect to torque generator **111**, when stance signal **220** indicates the presence of a force on the bottom of corresponding human foot (i.e., leg support **102** is in a stance phase) and angle signal **246** indicates that leg support **102** is either bent or postured to climb stairs or a slope. Throughout this application, climbing stairs and slopes are detected when the knee joint angle (shown as the angle "A" for knee joint **108** in FIG. 20) is bent or becomes smaller than a preset value at the beginning of the stance phase for a leg. In one embodiment, the preset value was chosen to be 135°. In another embodiment the preset value was chosen to be 165°.

[0052] In some embodiments, power unit **201** operates in the second mode with respect to torque generator **110**, when stance signal **219** indicates the presence of a force on the bottom of corresponding human foot (i.e., leg support **101** is in a stance phase) and angle sensor **245** detects that leg support **101** is neither bent nor postured to climb stairs or a slope. The same is true for torque generator **111**. Power unit **201** operates in second mode with respect to torque generator **111**, when stance signal **220** indicates the presence of a force on the bottom of corresponding human foot (i.e., leg support **102** is in a stance phase) and angle signal **246** indicates that leg support **102** is neither bent nor postured to climb stairs or a slope.

[0053] In some embodiments, power unit **201** operates in the third mode with respect to torque generator **110**, when stance signal **219** detects that leg support **101** is in a swing phase. The same is true for torque generators **111**. Power unit **201** operates in third mode with respect to torque generator **111**, when stance signal **220** detects that leg support **102** is in a swing phase.

[0054] In summary, power unit **201** is configurable to inject power into torque generators **110** and **111** during the stance phase of leg supports **101** and **102** and when they are bent or postured to climb stairs or slopes. To save power, during the stance phase of a leg support when it is not bent or postured to climb stairs or slopes, power unit **201** is configurable such that the energy required for the flexion and

extension between the shank link and the thigh link of a leg support over a cyclic knee motion can be provided by the person. To save even more power, during the swing phase of a leg support, power unit **201** is configurable such that the energy required for the flexion and extension between the shank link and the thigh link of a leg support over a cyclic knee motion can be provided by the person. Although throughout this application we refer to "climbing stairs or slopes" as the activities where power would be injected by power unit **201**, it is clear to one experienced in the art that other activities where lifting assistance is advantageous do exist (such as "coming out of squat position"). Therefore "climbing stairs or slopes" is meant to include any activity where injecting power from power unit **201** would be of advantage to the operator.

[0055] In operation, person **187** couples to (or wears) lower extremity exoskeleton **100** by coupling to human interface device **150** (a simple belt in this case of FIG. 1) and by coupling to two leg supports **101** and **102**. In some embodiments as shown in FIG. 1, leg supports **101** and **102** comprise shank holding devices **137** and **138** that couple person **187** to leg supports **101** and **102**.

[0056] In some embodiments torque generators **110** and **111** each comprise a hydraulic torque generator. Power unit **201** is capable of providing hydraulic power for torque generators **110** and **111** and among other components, as shown in FIG. 28, includes hydraulic circuitry **194** configured to be connectable to hydraulic torque generators **110** and **111**. Hydraulic circuitry **194** in power unit **201** modulates the hydraulic fluid flow to hydraulic torque generators **110** and **111**. Hydraulic torque generators **110** and **111** comprise of any hydraulic torque generator or combination of torque generators capable of converting pressurized hydraulic fluid into force or torque. Examples of hydraulic torque generators **110** and **111** include, without limitation, linear hydraulic piston-cylinders, rotary hydraulic actuators, rack-and-pinion-type rotary actuators and rotary hydraulic vane type actuators where pressurized hydraulic fluid, by pushing against moving surfaces, generate force or torque. An illustration of an exoskeleton utilizing rotary hydraulic systems is shown in FIG. 13. One skilled in the art will note, however, that it is possible to construct an exoskeleton with the functionality of this invention, where torque generators **110** and **111** and the power unit **201** are a combination of electrical devices possibly including a clutch. For example, the torque generator could be a ball screw and the power unit could be a combination of a clutch (to minimize the resistance to flexion and extension during swing) and an electric motor (to inject energy).

[0057] FIG. 29 shows an embodiment of the hydraulic circuitry **194**. Hydraulic circuitry **194** comprises a hydraulic pump **240**. In operation when power unit **201** operates in its first mode with respect to torque generator **110**, motor **241** turns hydraulic pump **240** and hydraulic pump **240** injects hydraulic fluid into torque generator **110** causing knee joint of leg support **101** to extend. Power unit **201** further comprises power storage component **238** (as shown in FIG. 28) such as batteries and capacitors to provide power for motor **241** and other components such as sensors and electronic components. Hydraulic circuitry **194** further comprises a pump isolating valve **239**. In operation, when power unit **201** operates in its first mode with respect to torque generator **110**, pump isolating valve **239** connects hydraulic pump

**240** to torque generator **110**. Hydraulic circuitry **194** further comprises an actuated flow restricting valve **200**.

[0058] In some embodiments, when leg support **101** is in a stance phase and is bent or positioned to climb stairs or a slope, power unit **201** operates in its first mode with respect to torque generator **110**. In this first mode, actuated flow restricting valve **200** is shut and pump isolating valve **239** is open. This allows hydraulic pump **240** to inject hydraulic fluid to hydraulic torque generator **110** from a source of hydraulic fluid (e.g. hydraulic reservoir **195** in FIG. **29**) causing knee joint **107** to extend.

[0059] In some embodiments, when leg support **101** is in a stance phase, but is not bent or positioned to climb stairs or a slope, power unit **201** operates in its second mode with respect to torque generator **110**. In this second mode, pump isolating valve **239** disconnects the fluid flow between hydraulic pump **240** and torque generator **110** and actuated flow restricting valve **200** restricts the fluid flow from torque generator **110**. This causes knee joint **107** to resist flexion.

[0060] In some embodiments, when leg support **101** is in a swing phase, power unit **201** operates in its third mode. In this third mode, actuated flow restricting valve **200** is open and allows for the minimum resistance hydraulic fluid flow between hydraulic torque generator **110** and a source of fluid (e.g., hydraulic reservoir **195**). This allows leg support **101** to be moved with little or no resistance.

[0061] In FIGS. **29** through **35**, hydraulic reservoir **195** is used to represent the source of fluid. One can use a double-acting hydraulic cylinder with rods on both ends of the piston instead of a single-acting hydraulic cylinder eliminating hydraulic reservoir **195**. Although it is shown by hydraulic reservoir **195**, source of fluid refers to either a hydraulic reservoir or the other chamber in a double acting hydraulic cylinder with rods on both ends.

[0062] Actuated flow restricting valve **200** comprises any valve or combination of valves capable of performing the indicated functions. Examples of actuated flow restricting valve **200** include, without limitation, flow control valve, pressure control valve, actuated needle valves, solenoid valves and on-off valve. Motor **241** comprises any device or combination of devices capable of driving hydraulic pump **240**. Examples of motor **241** include, without limitation, electric motors, including, without limitation, AC (alternating current) motors, brush-type DC (direct current) motors, brushless DC motors, electronically commutated motors (ECMs), stepping motors, and combinations thereof. In some embodiments motor **241** is an internal combustion device where a fuel is combusted to create motion. Although we state that electric motor **241** turns hydraulic pump **240**, one skilled in the art can realize that both motor **241** and hydraulic pump **240** may have other type of non-rotational couplings such as reciprocating linear motion.

[0063] FIG. **30** represents another embodiment of the hydraulic circuitry **194**. This embodiment is similar to embodiment of FIG. **29** but a hydraulic check valve (one way valve) **199** has been added that connects a source of hydraulic fluid (e.g., hydraulic reservoir **195**) to torque generator **110**. This allows free extension-of the knee joint of leg support **101** when power unit **201** operates in all three modes.

[0064] FIG. **31** represents another embodiment of the hydraulic circuitry **194** where a pump three-way valve **242**

connects hydraulic torque generator **110** to a hydraulic reservoir **195** either through an actuated flow restricting valve **200** or through a hydraulic pump **240**. When power unit **201** is operating in its first mode with respect to torque generator **110**, pump three-way valve **242** connects hydraulic torque generator **110** to hydraulic pump **240** otherwise pump three-way valve **242** connects hydraulic torque generator **110** to actuated flow restricting valve **200**. For example when leg support **101** is either bent or posed to climb stairs or a slope and is in stance phase, power unit operates in its first mode. In this first mode, pump three-way valve **242** connects hydraulic torque generator **110** to hydraulic reservoir **195** through hydraulic pump **240**. This allows hydraulic pump **240** to inject fluid to hydraulic torque generator **110** from hydraulic reservoir **195** causing knee joint **107** to extend. When leg support **101** is not postured to climb stairs or a slope, but is in a stance phase, power unit **201** operates in its second mode. In this second mode, pump three-way valve **242** connects hydraulic torque generator **110** to hydraulic reservoir **195** through actuated flow restricting valve **200**. Actuated flow restricting valve **200** restricts the hydraulic fluid flow from torque generator **110** causing knee joint **107** to resist flexion. When leg support **101** is in a swing phase, power unit **201** operates in its third mode. In this third mode, pump three-way valve **242** connects hydraulic torque generator **110** to hydraulic reservoir **195** through actuated flow restricting valve **200** and actuated flow restricting valve **200** opens and allows for the minimum resistance hydraulic fluid flow between hydraulic torque generator **110** and hydraulic reservoir **195**. This allows leg support **101** to be moved with little or no resistance.

[0065] FIG. **32** represents another embodiment of the hydraulic circuitry **194**. This embodiment is similar to embodiment of FIG. **31** but a check valve **199** has been added to allow for minimum resistance to extension of the knee joint of leg support **101** at all times.

[0066] FIG. **33** represents another embodiment of the hydraulic circuitry **194** where actuated flow restricting valve **200** has been removed. An additional hydraulic three-way valve **198** has been added which selects between a non-actuated flow restricting valve **196** and a bypass line **197**. The non-actuated flow restricting valve **196** can be a much simpler device and can either be a simple orifice or an adjustable device such as a needle valve. In operation, when leg support **101** is in a stance phase and is either bent or positioned to climb stairs or a slope, power unit **201** operates in its first mode. In this first mode, pump three-way valve **242** connects hydraulic torque generator **110** to hydraulic reservoir **195** through hydraulic pump **240**. This allows hydraulic pump **240** to inject fluid to hydraulic torque generator **110** from hydraulic reservoir **195** causing knee joint **107** to extend. When leg support **101** is in its stance phase, but is neither bent nor positioned to climb stairs or a slope, power unit **201** operates in its second mode. In this second mode, pump three-way valve **242** connects hydraulic torque generator **110** to hydraulic three-way valve **198**. Hydraulic three-way valve **198** connects pump three-way valve **242** to hydraulic reservoir **195** through non-actuated flow restricting valve **196** thereby reducing flow and increasing the impedance of hydraulic torque generator **110**. This causes knee joint **107** to resist flexion. When leg support **101** is in swing phase, power unit **201** operates in its third mode. In this third mode, pump three-way valve **242** connects hydraulic torque generator **110** to hydraulic three-way valve

**198.** Hydraulic three-way valve **198** connects pump three-way valve **242** to hydraulic reservoir **195** through bypass line **197** thereby increasing fluid flow and decreasing the impedance of hydraulic torque generator **110**. This allows leg support **101** to be moved with little or no resistance.

[**0067**] FIG. **34** represents another embodiment of the hydraulic circuitry **194**. This embodiment is similar to embodiment of FIG. **33** but a check valve **199** has been added to allow for minimum resistance to extension of the knee at all times.

[**0068**] It is important to note that there is a plethora of possible hydraulic circuits which could be used to create the behavior which is the subject of this invention. Inspection of various embodiments of the hydraulic circuitry **194**, reveals that each torque generator is coupled to a power injecting subcomponent of power unit **201**, capable of injecting power to a torque generator, and a power dissipating subcomponent of power unit **201** capable of dissipating power from the torque generator. For example, examination of FIG. **29** shows that actuated flow restricting valve **200** is power dissipating subcomponent while hydraulic pump **240** is a power injecting subcomponent. Power unit **201** selects which subcomponent torque generator will be connected to.

[**0069**] In some embodiments, as shown in FIG. **28**, power unit **201** further comprises a signal processor **159** capable of creating command signals for various components of power unit **201** to control power unit **201**. Signal processor comprises an element or combination of elements selected from a group consisting of analog devices; analog computation modules; digital devices including, without limitation, small-, medium-, and large-scale integrated circuits, application specific integrated circuits, programmable gate arrays, and programmable logic arrays; and digital computation modules including, without limitation, microcomputers, microprocessors, microcontrollers, and programmable logic controllers. In some embodiments signal processor **159** comprises an element or combination of elements selected from a group consisting of electromechanical relays or MOSFET switches. Signal processor **159** generates command signals for said hydraulic circuitry from stance signals **219** and **220**, and angle signals **245** and **246** or combination thereof.

[**0070**] It is also important to note that any of these hydraulic circuits could be used to capture energy when walking down a slope or stairs. Considering FIG. **29**, one can see that if the power unit detected that the operator were walking down a steep slope and the leg was in stance phase, the pump isolating valve **239** could be opened and actuated flow restricting valve **200** could be closed. This would divert fluid under pressure backwards into the hydraulic pump **240** which could then behave as a hydraulic motor (if properly configured) turning electric motor **241** backwards and generating electricity. If the energy storage medium in power unit **201** was capable of accepting such energy, like a battery, then this energy could be captured and used later to provide assistance during climbing a slope or stairs. (Note that power unit **201** can detect the condition of walking down a slope by observing a knee angle near **180** at the beginning of stance and a much lower angle at the end of stance). The system could behave as before during swing (providing minimum resistance to flexion or extension), during stance while climbing (injecting power), and during stance while walking

on near level ground (dissipating energy through a device such as a flow restricting valve.)

[**0071**] In fact, if hydraulic pump **240** and motor **241** could be designed to provide the correct amount of resistance to flexion during stance and minimal resistance during swing while walking on level ground, the actuated flow restricting valve **200** could be eliminated, and the simple system shown in FIG. **35** could be used. However, this would only be economical from a power consumption viewpoint, if the motor **241** would consume only negligible amounts of power or none at all while the leg was in stance while walking on level or near-level ground.

[**0072**] One skilled in the art will note that in all of these circuits, hydraulic reservoir **195** from one leg could be combined with the hydraulic reservoir from the other leg. Also, the separate motors **241**, hydraulic pump **240**, and reservoirs **195** could be combined in the form of a more traditional hydraulic power supply consisting of a low pressure reservoir, a single motor and hydraulic pump, a high pressure reservoir, and some control valves which let the correct flow of hydraulic fluid out of the high pressure reservoir and into each of the hydraulic torque generators. This design, however, is not as advantageous as a single motor per hydraulic torque generator, because of the large amount of power wasted by such control valves.

[**0073**] It should also be noted that all pressure relief valves have been omitted from the hydraulic diagrams for clarity.

[**0074**] Further discussing the geometry of the exoskeleton shown in FIG. **1**, in some embodiments as shown in FIG. **1**, exoskeleton trunk **109** includes two hip links **114** and **115** rotatably connectable to thigh links **103** and **104** at hip flexion-extension joints **125** and **126**, allowing for the flexion and extension of leg supports **101** and **102** about hip flexion-extension axes **151** and **152** respectively. In some embodiments, hip links **114** and **115** are rotatably connected to each other at abduction-adduction joint **113** allowing for abduction and/or adduction of leg supports **101** and **102**. Abduction and adduction of leg supports **101** and **102** are shown by arrows **217** and **218** respectively.

[**0075**] In some embodiments, the energy required for flexion and extension movement between leg supports **101** and **102** and exoskeleton trunk **109** over a cyclic hip motion is provided by said person. In some other embodiments, one can couple torque generators to hip joints **125** and **126**.

[**0076**] In some embodiments, exoskeleton trunk **109** is configured to hold a rear load **118** behind person **187**. In some embodiments, as shown in FIG. **1**, rear load **118** is held by hip links **114** and **115**. In some embodiments, exoskeleton trunk **109** further comprises extension frames **119** and **120** configured to hold a front load **154** in front of person **187**. In some embodiments (as shown in FIG. **1**) extension frames **119** and **120** are connectable to hip links **114** and **115**. Examples of rear load **118** and front load **154** include without limitation, backpack, baby carrier, food containers, sacks, water jugs, tool boxes, barrels, ammunition, weaponry, bedding, first aid supplies, golf bags, mail bags, camera, leaf blower, compressor, electromechanical machineries and combinations thereof. In some embodiments, rear load **118** and/or front load **154** are another person being carried by person **187**. In some embodiments, exoskeleton

trunk **109** supports a portion of the weight of person **187** through human interface device **150**.

[0077] FIG. 3 shows another embodiment of the invention where exoskeleton trunk **109** further comprises a hip resilient element **116** configured to apply a torque between hip links **114** and **115**. Examples of a hip resilient element include, without limitation, extension spring, compression spring, leaf spring, gas spring, air spring, rubber, elastomer, surgical tube, bungee cord and combinations thereof. The stiffness of hip resilient element **116** may be chosen such that its force generally holds up the weight of the leg supports **101** or **102** during swing phase.

[0078] Some embodiments, as shown in FIG. 3, may also include a hip abduction stop **211** which limits or prevents hip links **114** and **115** from abducting with respect to each other. In the particular embodiment shown in FIG. 3, abduction stop **211** is created using a wire rope. Wire rope **211** prevents abduction of leg supports **101** and **102** from occurring but allows adduction of leg supports **101** and **102**.

[0079] In accordance with another embodiment of the invention, FIG. 4 is a perspective drawing where exoskeleton trunk **109** includes two hip links **114** and **115** rotatably connectable to thigh links **103** and **104** allowing for flexion and extension of support legs **101** and **102** relative to exoskeleton trunk **109**, wherein hip links **114** and **115** are compliantly connected to each other allowing for abduction and/or adduction of leg supports **101** and **102**. In the example shown in FIG. 4, this is accomplished by leaf spring **153**.

[0080] In accordance with another embodiment of the invention, FIG. 5 is a perspective drawing wherein exoskeleton trunk **109** further comprises a connecting bracket **117** configured to transfer the weight of rear load **118** to exoskeleton trunk **109**. Exoskeleton trunk **109** further comprises two hip links **114** and **115** rotatably connectable to thigh links **103** and **104** allowing for flexion and extension of leg supports **101** and **102** relative to exoskeleton trunk **109**. Hip links **114** and **115** are rotatably connected to connecting bracket **117** via two hip abduction-adduction joints **176** and **177** and rotate about two hip abduction-adduction axes **178** and **179**. In some embodiments, hip abduction-adduction axes **178** and **179** are generally parallel to each other. In some embodiments, hip abduction-adduction joints **176** and **177** coincide with each other. Furthermore, in some embodiments, as shown in FIG. 6, hip abduction-adduction joints **176** and **177** coincide with each other forming hip abduction-adduction joint **113** and hip abduction-adduction axes **178** and **179** become one hip abduction-adduction axis **112**.

[0081] In some embodiments, as shown in FIG. 6, exoskeleton trunk **109** further comprises hip abduction-adduction resilient elements **121** and **122** configured to apply torques between hip links **114** and **115** and connecting bracket **117**. Examples of hip abduction-adduction resilient elements include, without limitation, extension spring, compression spring, gas spring, air spring, rubber, surgical tube, leaf springs, bungee cord and combinations thereof. The stiffness of hip abduction-adduction resilient elements **121** and **122** may be chosen such that its force generally holds up the weight of the leg supports **101** or **102** during swing phase and aid the person in keeping the load oriented vertically while walking. In some embodiments as shown in FIG. 7,

connecting bracket **117** further comprises extension frames **119** and **120** configured to hold front load **154** in front of person **187**.

[0082] In some embodiments, as shown in FIGS. 1, 5, 6 and 7, exoskeleton trunk **109** comprises human interface device **150** capable of coupling person **187** to lower extremity exoskeleton **100**. Examples of human interface device **150** comprise an element or combination of elements including, without limitation, vests, belts, straps, shoulder straps, chest straps, body cast, harness, and waist belts. In some embodiment human interface device **150** transfers a portion of the weight of person **187** to exoskeleton trunk **109**. FIG. 13 shows an embodiment where human interface device **150** comprises a specially-designed harness **229** to fit the body of person **187**. Harness **229** transfers a portion of the weight of person **187** to exoskeleton trunk **109**.

[0083] In some embodiments, as shown in FIG. 8, hip links **114** and **115** are compliantly connected to connecting bracket **117**. In the embodiment shown in FIG. 8, this is accomplished by a hip resilient member **153** which in this case is a leaf spring.

[0084] In some embodiments, as shown in FIG. 8, exoskeleton trunk **109** comprises a backpack frame **180** that allows a backpack to be coupled to lower extremity exoskeleton **100**. In some embodiments, backpack frame **180** is connected to connecting bracket **117**. The human interface devices **150** (such as a belt and shoulder straps) have been omitted in this figure for clarity.

[0085] In accordance with another embodiment, FIG. 9 is a perspective drawing wherein leg supports **101** and **102** further include thigh abduction-adduction joints **123** and **124** configured to allow abduction and/or adduction of leg supports **101** and **102** about axes **202** and **203** respectively. In some embodiments, thigh abduction-adduction joints **123** and **124** are located below hip flexion-extension joints **125** and **126**. These joints are shown in greater detail in FIG. 10 which is a partial view of the same embodiment of FIG. 9.

[0086] In some embodiments, as shown in FIG. 10, leg supports **101** and **102** comprise a thigh adduction stop **185** which limits or prevents thigh links **103** and **104** from adducting at joint **123** and **124**. Abduction and adduction of leg support **101** are shown by arrows **227** and **228** respectively. In the particular embodiment shown in FIG. 10, thigh abduction-adduction joint **123** includes a thigh adduction stop **185** which bears on a thigh stop surface **186**. Thigh adduction stop **185** limits the adduction of thigh abduction-adduction joint **123**. The unrestricted adduction of thigh abduction-adduction joint **123**, during stance phase, would cause hip link **114** to move downwardly along arrow **204** during stance thereby dropping (lowering) the load. Such abduction-only joints for joints **123** and **124** are useful in allowing the person to squat naturally. In some embodiments like the one shown in FIGS. 9 and 10, such abduction joints are generally located below hip flexion-extension joints **125** and **126**.

[0087] In some embodiments, as shown in FIGS. 9 and 10, leg supports **101** and **102** further include thigh rotation joints **127** and **128** configured to allow rotation of leg supports **101** and **102**. Rotation joints **127** and **128** are generally located above knee joints **107** and **108**. Lines **164** and **165** represent the rotation axes of rotation joints **127** and **128**. In FIG. 10

and 11, this is accomplished by providing for a sliding contact between the hip rotation shaft 166 and the hip rotation journal 168. The parts included in the joint which prevent it from pulling apart have been omitted for simplicity, but one skilled in the art will note that there are many ways of retaining such shafts in such journals.

[0088] In some embodiments, as shown in FIG. 11, rotation joints 127 and 128 further comprise a rotation resilient element 129. This rotation resilient element acts as a torsion spring and provides a restoring torque which generally restores the leg support back to the neutral position shown in FIG. 9. Rotation resilient element 129 can be constructed in many ways with the particular cross section shown in FIG. 111 being advantageous when using an elastomeric material to construct the element. Rotation resilient element 129 is shown partially deflected for illustration purposes.

[0089] Also, in some embodiments, as shown in FIG. 10 and FIG. 11, leg supports 101 and 102 further comprise compression-elongation mechanisms 131 and 132 configured to change the distance between exoskeleton trunk 109 and the respective knee flexion-extension joints 107 and 108. In some embodiments, compression-elongation mechanisms 131 and 132 allow for changes in the distance between the hip flexion-extension joints 125 and 126 and the respective knee flexion-extension joints 107 and 108. The compression-elongation mechanisms contracts by hip rotation shaft 166 sliding further into the hip rotation journal 168 (shown for leg 101 only). The leg rotation resilient element 129 is allowed to slide into a clearance cavity 170. In some embodiments, compression-elongation mechanism 131 and 132 further comprise a leg compression-elongation resilient element 133. This leg compression-elongation resilient element acts as a spring and provides a restoring force which generally restores the leg support back to a neutral configuration. In the embodiment of FIG. 11, this is illustrated by a helical compression spring.

[0090] In some embodiments, as shown in FIG. 12, lower extremity exoskeleton 100 further comprises two swing resilient elements configured to apply torque between thigh links 103 and 104 and exoskeleton trunk 109. In operation swing resilient element 221 pushes leg support 101 forward along arrows 222 during swing phase. This allows the person to swing the thigh links forward with less effort. In some embodiment swing resilient element 221 is a gas spring. Gas spring 221 includes a gas spring piston 223 and a gas spring cylinder 224. In operation the force of compressed gas 225 in gas spring cylinder 224 forces gas spring piston 223 against cam 226 thereby pushing leg support 101 along arrow 222. Examples of a swing resilient element 221, include, without limitation, extension spring, compression spring, leaf spring, gas spring, air spring, rubber, elastomer, surgical tube, bungee cord and combinations thereof. The stiffness of swing resilient element 221 may be chosen to give appropriate level of comfort.

[0091] In some embodiments, as shown in FIG. 9, exoskeleton trunk cover 171 may cover some components of exoskeleton trunk 109 including parts of hip links 114 and 115. The operation of the exoskeleton trunk is the same as in FIGS. 3 or 6 depending on the preferred choice of hip resilient element 116 or hip abduction-adduction resilient elements 121 and 122.

[0092] In some embodiments as shown in FIG. 9, thigh links 103 and 104 comprise thigh holding devices 135 and

136 configured to allow person 187 to couple to leg supports 101 and 102. Each thigh holding device 135 or 136 comprises an element or combination of elements including, without limitation, straps, bars, c-shape brackets, body cast, and elastomers. In some embodiments, as shown in FIG. 1, shank links 105 and 106 include comprise holding devices 137 and 138 configured to allow person 187 to couple to leg supports 101 and 102. Each shank holding device 137 and 138 comprises an element or combination of elements including, without limitation, straps, bars, c-shape brackets, body cast, and elastomers.

[0093] In some embodiments, as shown in FIG. 9, leg supports 101 and 102 further comprise exoskeleton feet 139 and 140 coupled to shank links 105 and 106 respectively, allowing the transfer of forces from shank links 105 and 106 to the ground. In operation, exoskeleton feet 139 and 140 are configurable to be coupled to the feet of person 187. In some embodiments, as shown in FIG. 9, the coupling to person's feet is accomplished by using clam-shell type bindings 205 and 206 sometimes found on modern snow shoes. However, there are a great number of methods to make such a connection as can be seen on different types of snow skis, snowboards, snowshoes and other such devices. In some embodiments, as shown in FIG. 14, exoskeleton feet 139 and 140 comprise exoskeleton shoes 188 and 189 wearable by person 187 thereby allowing exoskeleton feet 139 and 140 to couple to the feet of person 187. In some embodiments, as shown in FIG. 15, exoskeleton feet 139 and 140 comprise exoskeleton insoles 157 and 158 insertable inside the person's shoes, allowing exoskeleton feet 139 and 140 to couple to the feet of person 187. Insoles 157 and 158 are flexible and therefore can bend to match the curvature of the human foot during maneuvers such as squatting. Also, the insole side supports 212 are either compliant or configured to include degrees of freedom to mimic the movement of the human ankle.

[0094] In some embodiments, as shown in FIG. 9, exoskeleton feet 139 and 140 are compliantly coupled to shank links 105 and 106. This is accomplished using ankle resilient elements 181 and 182. FIG. 16 shows a close-up view of exoskeleton feet 139. In this example, ankle resilient elements 181 (and 182) each are constructed of a metal ball-and-socket joint 231 surrounded by an elastomer donut shape element 230 which creates compliance in all directions of rotations.

[0095] In some embodiments, exoskeleton feet 139 and 140 rotate about two plantar-dorsi flexion axes relative to shank links 105 and 106. FIG. 17 shows an embodiment of this type of exoskeleton where ankle plantar-dorsi flexion axis 172 is generally parallel to the plantar-dorsi flexion axis in the human ankle. In some embodiments, each leg support further comprises at least one ankle plantar-dorsi flexion resilient element 141 resisting the rotation of respective exoskeleton foot about ankle plantar-dorsi flexion axis 172.

[0096] In some embodiments, as shown in FIG. 18, exoskeleton feet 139 and 140 rotate about two ankle abduction-adduction axes 174 relative to shank links 105 and 106. FIG. 18 shows an embodiment of this type of exoskeleton where ankle abduction-adduction axis 174 is generally parallel to the abduction-adduction axis in the human ankle. In some embodiments each leg support further comprises at least one

ankle abduction-adduction resilient element 142 resisting the rotation of exoskeleton foot 139 about ankle abduction-adduction axis 174.

[0097] In some embodiments, as shown in FIG. 19, exoskeleton feet 139 and 140 rotate about two ankle rotation axes 147 and 148 relative to shank links 105 and 106. In some cases, this is accomplished using a shank rotation joint 207 which functions similar to leg rotation joint 127. FIG. 19 shows an embodiment of this type of exoskeleton where ankle rotation axis 147 is generally parallel to the rotation axis in the human ankle. In some embodiments, resilient elements can be included in the ankle to resist the rotation of the exoskeleton foot 139 about ankle rotation axis 147.

[0098] In some embodiments, as shown in FIG. 22, foot sensors 160 are integrated into exoskeleton feet 139 and 140. In some embodiments, as shown in FIG. 22, foot sensor 160 is a pressure sensor measuring the pressure in a media 191 trapped in a foot sensor cavity 192 inside exoskeleton foot 139. FIG. 16 shows an embodiment where a tube is used as a foot sensor cavity 192. Pressure sensor 160 measures the pressure in a media 191 trapped in a foot sensor cavity 192. In some cases, the stance signal 219 may take the form of the media 191 itself ported in a small tube from the cavity 192 to signal processor 159.

[0099] FIG. 23 shows another embodiment wherein foot sensor 160 is a force sensor connectable to exoskeleton foot 139. In some embodiments, as shown in FIG. 24, foot sensor 160 is located inside the human shoe like an insole and its output signal represents the force on the bottom of the human foot. This type would be particularly useful in embodiments of the invention such as those shown in FIG. 14 or 15. In some embodiments, as shown in FIG. 25, foot sensor 160 is connected to the bottom of the human shoe and senses the force on the bottom of the human foot. In some embodiments, as shown in FIG. 26, foot sensor 160 is located inside the human shoe sole and senses the force on the bottom of the human foot.

[0100] Foot sensor 160 comprises any sensor or combination of sensors capable of performing the indicated functions. Examples of foot sensor 160 include, without limitation, force sensors, strain-gage based force sensors, piezoelectric force sensors, force sensing resistors, pressure sensors, switches, tape switches and combinations thereof. In some embodiments foot sensor 160 is a switch that represents the existence of a force greater than some threshold force on the bottom of the foot of person 187.

[0101] In some embodiments lower extremity exoskeleton 100 further includes two compliant elements connecting thigh links 103 and 104 to exoskeleton trunk 109 assisting the operator in swinging the leg forward. This allows the operator to swing the thigh links forwardly with less effort. FIG. 27 shows an embodiment of the invention where tensile spring 233 connects thigh link 103 to hip link 114 via extension frame 119. Similarly tensile spring 234 connects thigh link 104 to hip link 115 via extension frame 120.

[0102] Also shown in FIG. 21 is an additional thigh abduction-adduction joint 235 which is included in order to allow the leg to be stowed in a vertical position when the exoskeleton is not in use but needs to be carried. Leg support 101 can abduct along axis 237. This may be desirable if the operator no longer has a very heavy load to carry but needs

to transport lower extremity exoskeleton 100. In that case, the operator may unstrap the exoskeleton's right leg support 101 and swing the leg outward from his or her body until the right exoskeleton foot 139 is in the air over the operator's head. Then by bending the right knee joint 107 and/or rotating the right leg rotation joint 127, the leg can be positioned such that it stows behind the operator as shown in FIG. 36. This is possible because the right thigh abduction-adduction joint 123 and the additional right thigh abduction-adduction joint 235 each allow for a rotation of approximately ninety degrees about the right thigh abduction-adduction axis 202 and the additional right thigh abduction-adduction axis 237 respectively. The total abduction possible therefore is over 180 degrees. This could be accomplished with one thigh abduction-adduction joint which has 180 degrees of travel, but designing such a joint would cause the designer to move the pivot point of the joint outward from the operator a great deal which would result in a wider exoskeleton design. This is undesirable but is a viable alternative design.

[0103] Although various exemplary embodiments have been described, it will be appreciated by persons skilled in the art that numerous variations and/or modifications may be made to the described device as specifically shown here without departing from the spirit or scope of that broader disclosure. The various examples are, therefore, to be considered in all respects as illustrative and not restrictive.

1. A lower extremity exoskeleton, configurable to be coupled to a person, said lower extremity exoskeleton comprising:

two leg supports configurable to be coupled to said person's lower limbs and configured to rest on the ground during their stance phases, wherein each said leg support comprises a thigh link and a shank link;

two knee joints, each configured to allow flexion and extension between respective shank link and respective thigh link; and

an exoskeleton trunk configurable to be coupled to said person's upper body, rotatably connectable to said thigh links of said leg supports allowing for the flexion and extension between said leg supports and said exoskeleton trunk;

two torque generators coupled to each said knee joints; and

a power unit, capable of providing power, coupled to said torque generators, wherein the power unit is configured to operate in at least two modes for each torque generator, wherein:

when said power unit operates in its first mode with respect to one of said torque generators, said power unit injects power into that torque generator to extend a respective knee angle defined between the respective shank link and respective thigh link, and

when said power unit operates in its second mode with respect to one of said torque generators, the energy required for said flexion and extension between the shank link and the respective thigh link of said corresponding leg support over a cyclic knee motion is provided by said person but said power unit causes the torque generator to resist flexion.

2. The device of claim 1 wherein said power unit further operates in a third mode with respect to a torque generator, wherein:

when said power unit operates in said third mode with respect to one of said torque generators, the energy required for said flexion and extension between the shank link and the respective thigh link of said corresponding leg support over a cyclic knee motion is provided by said person, and wherein the torque generator's resistance to knee flexion and extension is minimized.

3. The device of claim 1 wherein the energy required for flexion and extension movement between a thigh link and said exoskeleton trunk over a cyclic hip motion is provided by said person.

4. The lower extremity exoskeleton of claim 2 wherein said lower extremity exoskeleton comprises at least one foot sensor per said leg support which produces a stance signal representing force on the bottom of each person's foot, and wherein said power unit controls said torque generators as a function of said stance signals.

5. The lower extremity exoskeleton of claim 4 wherein said lower extremity exoskeleton further comprises at least one angle sensor per said leg support which produces an angle signal representing the knee angle, wherein said power unit controls said torque generators as a function of said angle signals.

6. The device of claim 5 wherein said power unit operates in said first mode with respect to one of said torque generators when said corresponding stance signal indicates the presence of a force on the bottom of corresponding human foot and said corresponding angle sensor detects that said corresponding leg support is either bent or postured to climb stairs or a slope.

7. The device of claim 5 wherein said power unit operates in said first mode with respect to one of said torque generators, when said corresponding stance signal indicates the presence of a force on the bottom of corresponding human foot and said corresponding angle signal indicates that said corresponding leg support is in a position from which to extend said knee.

8. The device of claim 5 wherein said power unit operates in said second mode with respect to one of said torque generators, when said corresponding stance signal indicates the presence of a force on the bottom of corresponding human foot and said corresponding angle signal indicates that said corresponding leg support is neither bent nor postured to climb stairs or a slope.

9. The device of claim 4 wherein said power unit operates in said third mode with respect to one of said torque generators when said corresponding stance signal detects that a leg support is in a swing phase.

10. The device of claim 1 wherein each said torque generator comprises a hydraulic torque generator, and wherein said power unit, capable of providing hydraulic power, includes a hydraulic circuitry connectable to said hydraulic torque generators, wherein said hydraulic circuitry is configured to control said hydraulic torque generators by modulating the hydraulic fluid flow to and from said hydraulic torque generators.

11. The device of claim 10 wherein said hydraulic torque generator is a hydraulic piston-cylinder.

12. The device of claim 10 wherein said hydraulic torque generator is a rotary hydraulic vane type torque generator.

13. The device of claim 10 wherein said hydraulic circuitry comprises a hydraulic pump coupled to a motor, wherein when said power unit operates in said first mode with respect to one of said torque generators, said hydraulic pump injects hydraulic fluid into that torque generator causing knee joint of said corresponding leg support to extend.

14. The device of claim 13 wherein said hydraulic circuitry further comprises a pump isolating valve, wherein when said power unit operates in said first mode with respect to one of said torque generators, said pump isolating valve connects said hydraulic pump to that torque generator.

15. The device of claim 13 wherein said hydraulic circuitry further comprises an actuated flow restricting valve, wherein when said power unit operates in said second mode with respect to one of said torque generators, said actuated flow restricting valve restricts the fluid flow from that torque generator.

16. The device of claim 15 wherein when said power unit operates in a third mode with respect to one of said torque generators, said actuated flow restricting valve opens and allows for minimum resistance hydraulic fluid flow between that torque generator and a source of hydraulic fluid.

17. The device of claim 13 wherein said motor is an electric motor, wherein when said power unit operates in a power regeneration mode with respect to one of said torque generators, that torque generator injects hydraulic fluid into said hydraulic pump, which then acts as a hydraulic motor, causing said electric motor, which then acts as an electric generator, to generate electricity.

18. The device of claim 10 wherein said hydraulic circuitry further comprises a hydraulic check valve connecting a source of hydraulic fluid to said torque generator allowing for free extension of said knee when said power units operates in all said modes.

19. The device of claim 15 wherein said hydraulic circuitry further comprises a three-way valve, wherein when said power unit is operating in said first mode with respect to one of said torque generators, said three-way valve connects that hydraulic torque generator to said hydraulic pump; otherwise, said three-way valve connects that hydraulic torque generator to said actuated flow restricting valve.

20. The device of claim 5 wherein said power unit further comprises a signal processor capable of controlling said power unit.

21. The device of claim 20 wherein said signal processor comprises an element or combination of elements selected from a group consisting of analog devices; analog computation modules; digital devices including, without limitation, small-, medium-, and large-scale integrated circuits, application specific integrated circuits, programmable gate arrays, and programmable logic arrays; and digital computation modules including, without limitation, microcomputers, microprocessors, microcontrollers, and programmable logic controllers.

22. The device of claim 20 wherein signal processor comprises an element or combination of elements selected from a group consisting of electromechanical relays or MOSFET switches.

23. The device of claim 20 wherein signal processor generates command signals for said hydraulic circuitry from said stance signals, said angle signal, or combination of stance signals and angle signals.



24. The device of claim 1 wherein said power unit comprises a power injecting subcomponent capable of injecting power to a torque generator, and a power dissipating subcomponent capable of dissipating power from the torque generator.

25. The device of claim 1 wherein said exoskeleton trunk further allows for rotation of each said leg support about an abduction-adduction axis generally parallel to ground.

26. The device of claim 1 wherein said exoskeleton trunk further comprises two hip links rotatably connectable to said respective thigh links to allow for said flexion and extension of said support legs relative to said exoskeleton trunk; wherein said hip links are rotatably connected to each other to allow for abduction of leg supports.

27. The device of claim 1 wherein said exoskeleton trunk further comprises two hip links rotatably connectable to said respective thigh links to allow for said flexion and extension of said support legs relative to said exoskeleton trunk; wherein said hip links are rotatably connected to each other to allow for adduction of leg supports.

28. The device of claim 1 wherein said exoskeleton trunk is configured to hold a rear load behind said person when said exoskeleton trunk is coupled to said person's upper body.

29. The device of claim 1 wherein said exoskeleton trunk further comprises an extension frame configured to hold a front load in front of said person when said exoskeleton trunk is coupled to said person's upper body.

30. The device of claim 26 wherein said exoskeleton trunk further comprises a hip resilient element configured to apply a torque between said hip links.

31. The device of claim 27 wherein said exoskeleton trunk further comprises a hip resilient element configured to apply a torque between said hip links.

32. The devices of claims 30 and 31 wherein said hip resilient element comprises an elastic element or combination of elastic elements selected from a group consisting of extension spring, compression spring, leaf spring, air spring, gas spring, rubber, elastomer, surgical tube, and bungee cord.

33. The device of claim 26 wherein said exoskeleton trunk further comprises a hip abduction stop to limit the abduction of said hip links with respect to each other.

34. The device of claim 1 wherein said exoskeleton trunk further comprises two hip links rotatably connectable to said respective thigh links allowing for said flexion and extension of said support legs; wherein said hip links are compliantly connected to each other allowing for adduction of leg supports.

35. The device of claim 1 wherein said exoskeleton trunk further comprises two hip links rotatably connectable to said respective thigh links allowing for said flexion and extension of said support legs; wherein said hip links are compliantly connected to each other allowing for abduction of leg supports.

36. The device of claim 1 wherein said exoskeleton trunk further comprises a connecting bracket configured to transfer weight of a load to said exoskeleton trunk.

37. The device of claim 36 wherein said exoskeleton trunk further comprises two hip links rotatably connectable to said respective thigh links to allow for said flexion and extension of said support legs relative to said exoskeleton trunk; wherein said hip links are rotatably connected to said

connecting bracket via two hip abduction-adduction joints to allow for rotational motion of said leg supports about two abduction-adduction axes.

38. The device of claim 37 wherein said abduction-adduction axes are generally parallel to each other.

39. The device of claim 37 wherein said abduction-adduction joints coincide on each other.

40. The device of claim 36 wherein said load is an object selected from a group consisting of backpack, baby carrier, food containers, sacks, water jugs, tool boxes, barrels, ammunition, weaponry, bedding, first aid supplies, golf bags, mail bags, camera, leaf blower, compressor, electro-mechanical machineries and combinations thereof.

41. The device of claim 36 wherein said load is another person.

42. The device of claim 37 wherein said exoskeleton trunk further comprises hip abduction-adduction resilient elements configured to apply torques between said hip links and said connecting bracket.

43. The device of claim 42 wherein said hip abduction-adduction resilient elements, each comprises an elastic element or combination of elastic elements selected from a group consisting of extension spring, compression spring, leaf spring, air spring, gas spring, rubber, elastomer, surgical tube, and bungee cord.

44. The device of claim 36 wherein said connecting bracket further comprises an extension frame configured to hold said load in front of said person when said exoskeleton trunk is coupled to said person's upper body.

45. The device of claim 36 wherein said exoskeleton trunk comprises a human interface device capable of coupling said person's upper body to lower extremity exoskeleton.

46. The device of claim 45 wherein said human interface device is capable of transferring a portion of the weight of said person to said exoskeleton trunk.

47. The device of claim 45 wherein said human interface device comprises an element or combination of elements selected from a group consisting of vests, belts, straps, shoulder straps, chest straps, body cast, harness, and waist belts.

48. The device of claim 35 wherein said exoskeleton trunk further comprises two hip links rotatably connectable to said respective thigh links allowing for said flexion and extension of said support legs wherein said hip links are compliantly connected to each other allowing for adduction of leg supports.

49. The device of claim 1 wherein said thigh link of each said leg support further includes a thigh abduction-adduction joint configured to allow abduction of said perspective leg support.

50. The device of claim 49 wherein said abduction-adduction joints are generally located below said hip flexion-extension joints.

51. The device of claim 1 wherein said thigh of each said leg support further includes a thigh abduction-adduction joint configured to allow adduction of said leg support.

52. The device of claim 51 wherein said abduction-adduction joints are generally located below said hip flexion-extension joints.

53. The device of claim 1 wherein each said leg support further includes a leg rotation joint configured to allow rotation of said leg support.

54. The device of claim 53 wherein said leg rotation joints are generally located above said knee flexion-extension joints.

55. The device of claim 53 wherein said leg rotation joints further comprise a leg rotation resilient element that provides a restoring torque which generally restores said leg support back to a neutral position.

56. The device of claim 1 wherein said thigh link of each said leg support further includes a compression-elongation mechanism configured to allow a change in the distance between said hip flexion-extension joint and said knee flexion-extension joint.

57. The device of claim 56 wherein said compression-elongation mechanism comprises a leg compression-elongation resilient element that provides a restoring force which generally restores said leg support back to a neutral configuration.

58. The device of claim 1 further comprising two swing resilient elements configured to apply torque between said thigh links and said exoskeleton trunk.

59. The device of claim 1 wherein said thigh links include thigh holding devices configured to allow said person to couple to said leg supports.

60. The device claim 59 wherein each said thigh holding device comprises an element or combination of elements selected from a group consisting of strap, bar, c-shape brackets, body cast and elastomers.

61. The device of claim 1 wherein said shank links include shank holding devices configured to allow said person to couple to said leg supports.

62. The device claim 61 wherein each said shank holding device comprises an element or combination of elements selected from a group consisting of strap, bar, c-shape brackets, body cast and elastomers.

63. The device of claim 1 wherein each said leg support further comprises an exoskeleton foot configured to be coupled to respective said person's foot and coupled to respective said shank link to allow the transfer of forces from said shank link to the ground.

64. The device of claim 1 wherein each said leg support further comprises an exoskeleton foot coupled to respective said shank link and configured to be coupled to the bottom of the said respective person's shoe to allow the transfer of forces from said shank link to the ground.

65. The device of claim 63 wherein each said exoskeleton foot further comprises a shoe wearable by said person to allow said exoskeleton foot to couple said person's foot.

66. The device of claim 63 wherein each said exoskeleton foot further comprises an exoskeleton insole insertable inside said person's shoe to allow said exoskeleton foot to couple said person's foot.

67. The device of claim 1 wherein each said leg support further comprises an exoskeleton foot configured to be coupled to respective said person's foot and compliantly coupled to respective said shank link to allow the transfer of forces from said shank link to the ground.

68. The device of claim 1 wherein each said leg support further comprises an exoskeleton foot configured to be coupled to respective said person's foot and rotatably coupled to respective said shank link to allow the transfer of forces from said shank link to the ground; said exoskeleton foot rotates about an ankle plantar-dorsi flexion axis generally parallel to plantar-dorsi flexion axis in the human ankle.

69. The device of claim 68 wherein each said leg support further comprises at least one ankle plantar-dorsi flexion resilient element resisting the rotation of respective said exoskeleton foot about said ankle plantar-dorsi flexion axis.

70. The device of claim 1 wherein each said leg support further comprises an exoskeleton foot configured to be coupled to respective said person's foot and rotatably coupled to respective said shank link to allow the transfer of forces from said shank link to the ground; said exoskeleton foot rotates about an ankle abduction-adduction axis generally parallel to abduction-adduction axis in the human ankle.

71. The device of claim 70 wherein said each leg support further comprises at least one ankle abduction-adduction resilient element to resist the rotation of respective said exoskeleton foot about said ankle abduction-adduction axis.

72. The device of claim 1 wherein each said leg support further comprises an exoskeleton foot configured to be coupled to respective said person's foot and rotatably coupled to respective said shank link to allow the transfer of forces from said shank link to the ground; said exoskeleton foot rotates about an ankle rotation axis generally parallel to rotation axis in the human ankle.

73. The device of claim 72 wherein each said leg support further comprises at least one resilient element to resist the rotation of respective said exoskeleton foot about said ankle rotation axis.

74. A method of operating a lower extremity exoskeleton, said lower extremity exoskeleton comprising:

two leg supports configurable to be coupled to said person's lower limbs and configured to rest on the ground during their stance phases, wherein each said leg support comprises a thigh link and a shank link;

two knee joints, each configured to allow flexion and extension between respective shank link and respective thigh link; and

an exoskeleton trunk configurable to be coupled to said person's upper body, rotatably connectable to said thigh links of said leg supports allowing for the flexion and extension between said leg supports and said exoskeleton trunk;

two torque generators coupled to each said knee joints; said method comprising:

coupling a person to said exoskeleton;

allowing the flexion of said respective knee joints during swing phase;

resisting flexion of said respective knee joints during stance phase when said leg support is not posed to climb stairs or a slope; and

injecting power into respective torque generator during stance phase to extend a respective knee angle when said leg support is posed to climb stairs or a slope.

75. A method of carrying an object using a lower extremity exoskeleton, said lower extremity exoskeleton coupled to said object and having:

two leg supports configurable to be coupled to said person's lower limbs and configured to rest on the ground during their stance phases, wherein each said leg support comprises a thigh link and a shank link;

two knee joints, each configured to allow flexion and extension between respective shank link and respective thigh link; and

an exoskeleton trunk configurable to be coupled to said person's upper body, rotatably connectable to said thigh links of said leg supports allowing for the flexion and extension between said leg supports and said exoskeleton trunk;

two torque generators coupled to each said knee joints; and

a power unit coupled to said torque generators

said method comprising:

coupling a person to said exoskeleton;

coupling said object to said exoskeleton;

allowing the flexion of said respective knee joints during swing phase;

resisting flexion of said respective knee joints during stance phase when said leg support is not posed to climb stairs or a slope; and

injecting power into respective torque generator during stance phase to extend a respective knee angle when said leg support is posed to climb stairs or a slope.

**76.** A method of stowing an exoskeleton leg, said exoskeleton leg having thigh link and a shank link, said method comprising:

abducting the leg about a joint or joints which allow the leg to abduct a full 180 degrees when not fastened to the operator.

**77.** A system to operate an artificial knee disposed between a thigh link and a shank link, wherein a knee angle is defined between the thigh link and the shank link, system comprising:

a hydraulic actuator coupled to said artificial knee; and

a power unit coupled to the hydraulic actuator, wherein said power unit is configured to operate in at least two modes, wherein:

when said power unit operates in its first mode with respect to said hydraulic actuator, said power unit injects power into that hydraulic actuator to extending said knee angle;

when said power unit operates in its second mode with respect to said hydraulic actuator, the energy required for said flexion and extension between the shank link and the respective thigh link of said artificial knee over a cyclic knee motion is provided by a person but said power unit causes the torque generator to resist flexion.

**78.** A lower extremity exoskeleton, configurable to be coupled to a person, said lower extremity exoskeleton comprising:

two leg supports configurable to be coupled to said person's lower limbs and configured to rest on the ground during their stance phases, wherein each said leg support comprises a thigh link and a shank link;

two knee joints, each configured to allow flexion and extension between respective shank link and respective thigh link;

an exoskeleton trunk configurable to be coupled to said person's upper body, rotatably connectable to said thigh links of said leg supports allowing for the flexion and extension between said leg supports and said exoskeleton trunk;

two torque generators coupled to each said knee joints; and

a power unit comprising a hydraulic pump coupled to a motor, and an actuated flow restricting valve, wherein:

when said power unit operates in a first mode with respect to one of said torque generators, said hydraulic pump injects hydraulic fluid into that torque generator to cause said knee joint of said corresponding leg support to extend and,

when said power unit operates in a second mode with respect to one of said torque generators, the energy required for said flexion and extension between the shank link and the respective thigh link of said corresponding leg support over a cyclic knee motion is provided by said person and said actuated flow restricting valve restricts the fluid flow from that torque generator.

**79.** The device of claim 78 wherein when said power unit operates in a third mode with respect to one of said torque generators, the energy required for said flexion and extension between the shank link and the respective thigh link of said corresponding leg support over a cyclic knee motion is provided by said person and said actuated flow restricting valve opens and allows for minimum resistance hydraulic fluid flow between that torque generator and a source of hydraulic fluid.

**80.** The device of claim 78 wherein said motor is an electric motor, wherein when said power unit operates in a power regeneration mode with respect to one of said torque generators, that torque generator injects hydraulic fluid into said hydraulic pump, which then acts as a hydraulic motor, causing said electric motor, which then acts as an electric generator, to generate electricity.

\* \* \* \* \*